

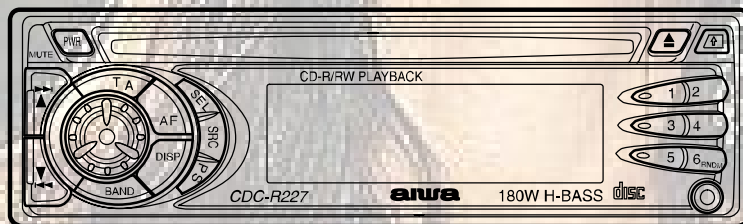

# CDC-R227 YZ(S)



## SERVICE MANUAL

STEREO CAR CD STEREO

BASIC CD MECHANISM : BZG-3 CNF

•This service Manual is the “Revision Publishing” and replaces “Simple Manual” CDC-R227 <YZ(S)> (S/M Code No.09-026-458-8T1)

# aiwa

S/M Code No. 09-026-458-8R1

REVISION

DATA

## TABLE OF CONTENTS -1/1

SPECIFICATIONS .....	3
PROTECTION OF EYES FROM LASER BEAM DURING SERVICING .....	4
PRACAUTION TO REPLACE OPTICAL BLOCK (OPTIMA720 JVC) .....	5
CAUTION WHEN SERVICING .....	6
ACCESSORIES PARTS LIST .....	7
ELECTRICAL PARTS LIST .....	8 ~ 17
TRANSISTOR ILLUSTRATION .....	18
SCHEMATIC DIAGRAM – 1 (MAIN) .....	19
WIRING – 1 (MAIN) .....	20
SCHEMATIC DIAGRAM – 2 (FRONT / AUX) .....	21
WIRING – 2 (FRONT / AUX) .....	22,23
SCHEMATIC DIAGRAM – 3 (CD / FLEX / SW) .....	24
WIRING – 3 (CD) .....	25,26
WIRING – 4 (FLEX / SW) .....	27
VOLTAGE CHART .....	28 ~ 31
LCD DIAGRAM (CKC-A-G-H) .....	32,33
IC BLOCK DIAGRAM .....	34 ~ 37
IC DESCRIPTION .....	38 ~ 42
MECHANICAL EXPLODED VIEW .....	43
MECHANICAL PARTS LIST .....	44
COLOR NAME TABLE .....	45
CD MECHANISM EXPLODED VIEW (BZG-3 CNF) .....	46
CD MECHANISM PARTS LIST (BZG-3 CNF) .....	47,48
OTHER PARTS LIST (CDC-R227) .....	49
OTHER PARTS LIST (BZG-3 CNF) .....	50

## SPECIFICATIONS -1/1

### RADIO SECTION

#### (FM)

**Frequency Range:** 87.5 MHz – 108 MHz

**Usable Sensitivity:** 12.7 dBf

**50 dB Quieting Sensitivity:** 17.2 dBf

**IF Rejection:** 100 dB

**Frequency Response:** 30 Hz – 15,000 Hz

**S/N Ratio:** 67 dB

**Stereo Separation:** 35 dB at 1 kHz

**Alternate Channel Selectivity:** 98 dB

**Capture Ratio:** 3 dB

#### (MW)

**Frequency Range:** 531 kHz – 1,602 kHz

**Usable Sensitivity:** 30  $\mu$ V (30 dB)

#### (LW)

**Frequency Range:** 144 kHz – 288 kHz (1-kHz/9-kHz setps)

**Usable Sensitivity:** 30  $\mu$ V (30 dB)

### CD SECTION

**Frequency Response:** 17 Hz – 20 kHz +0/-3 dB

**Dynamic Range:** More than 92 dB

**Channel Separation:** More than 60 dB

**S/N Ratio:** More than 92 dB

**Wow/Flutter:** Unmeasurable

### AUDIO SECTION

**Max. Power Output:** 45 W x 4 channels

#### AUX input

**Input Sensitivity (load impedance) AUX:** 300 mV (10 kohm)

### GENERAL

**Power-Supply Voltage:** 14.4 V (11 to 16 V allowable),  
DC, negative ground

**Load Impedance:** 4 ohm

#### Tone Control:

Bass  $\pm$  10 dB at 100 Hz, Treble  $\pm$  10 dB at 10 kHz

**Preamp Output Voltage (load impedance):** 2.2 V (10 kohm)

**Installed Size:** 182 (W) x 53 (H) x 155 (D) mm

**Supplied Accessory:** Carrying case(1)

- Design and specifications are subject to change without notice.

## PROTECTION OF EYES FROM LASER BEAM DURING SERVICING -1/1

This set employs laser. Therefore, be sure to follow carefully the instructions below when servicing.

### WARNING!

WHEN SERVICING, DO NOT APPROACH THE LASER EXIT WITH THE EYE TOO CLOSELY. IN CASE IT IS NECESSARY TO CONFIRM LASER BEAM EMISSION. BE SURE TO OBSERVE FROM A DISTANCE OF MORE THAN 30cm FROM THE SURFACE OF THE OBJECTIVE LENS ON THE OPTICAL PICK-UP BLOCK.

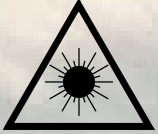

- Caution: Invisible laser radiation when open and interlocks defeated avoid exposure to beam.
- Advarsel: Usynlig laserstråling ved åbning, når sikkerhedsafbrydere er ude af funktion. Undgå udsættelse for stråling.

### VAROITUS!

Laiteen Käyttäminen muulla kuin tässä käyttöohjeessa mainitulla tavalla saattaa altistaa käyttäjän turvallisuusluokan 1 ylitävälle näkymättömälle lasersäteilylle.

### VARNING!

Om apparaten används på annat sätt än vad som specificeras i denna bruksanvisning, kan användaren utsättas för osynlig laserstråling, som överskrider gränsen för laserklass 1.

### CAUTION

Use of controls or adjustments or performance of procedures other than those specified herein may result in hazardous radiation exposure.

### ATTENTION

L'utilisation de commandes, réglages ou procédures autres que ceux spécifiés peut entraîner une dangereuse exposition aux radiations.

### ADVARSEL!

Usynlig laserstråling ved åbning, når sikkerhedsafbrydere er ude af funktion. Undgå udsættelse for stråling.

This Compact Disc player is classified as a CLASS 1 LASER product.  
The CLASS 1 LASER PRODUCT label is located on the rear exterior.

CLASS 1	LASER PRODUCT
KLASSE 1	LASER PRODUKT
LUOKAN 1	LASER LAITE
KLASS 1	LASER APPARAT

## PRECAUTION TO REPLACE OPTICAL BLOCK -1/1 (OPTIMA720 JVC)

Body or clothes electrostatic potential could ruin laser diode in the optical block. Be sure ground body and workbench, and use care the clothes do not touch the diode.

- 1) After the connection, remove solder shown in the right figure.

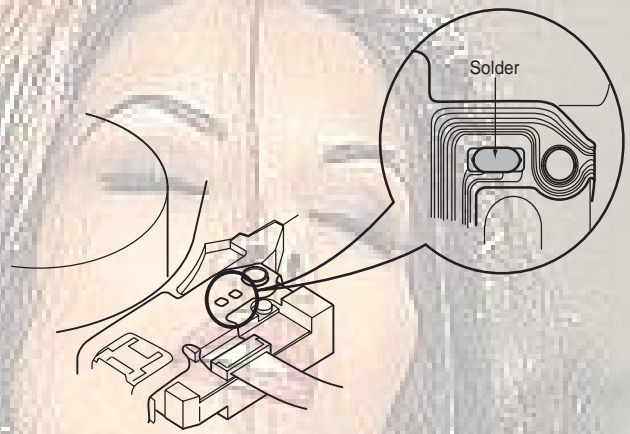



## CAUTION WHEN SERVICING -1/1

### 1. Procedure For Disassembly

- 1) Remove COVER TOP and COVER BOTTOM.
- 2) Remove the screws (indicated with arrows) from CD MECHANISM. Refer to Fig. 1

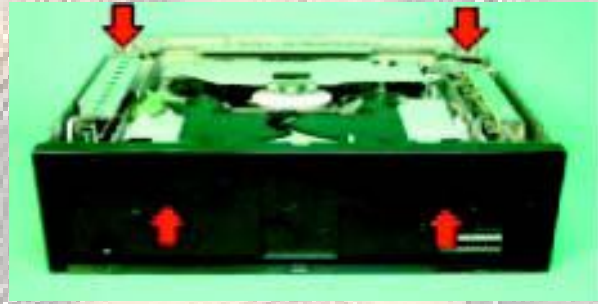

Fig-1

### 2. Servicing Position

- Remove CD MECHANISM and check the movement while in a stable condition. Refer to Fig-2



Fig-2

# ACCESSORIES PARTS LIST -1/1

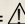
- ! =  SAFETY PARTS
- C = Components marked

All components used on this model at the production line are shown in this service manual.  
 However, please note that not all components will be available as spare parts for after-sales service.  
 Components marked S and O are designated as spare parts for service and will be stocked at the spare parts centers.  
 Components marked X and R are not designated as spare parts for after sales service, and will not be stocked at the spare parts centers.

UNIT-NAME	! C	REF-NO	PARTS-NO	PARTS-NAME	SUFFIX&MODEL
					CDC-R227
					YZSF
	O	AS1001	87-253-033-410	U+2-4 BLK	a
	O	AS1002	87-B10-141-010	NUT,5 TYPE-2	a
	O	AS1003	87-B10-143-010	UT1+5-15 W/O SLOT	a
	O	AS1004	87-B10-144-010	W,5.2-10-0.5	a
	O	AS1005	87-B10-145-010	W-SPR,5.3-8.5-1.5	a
	O	AS1006	8C-KCG-060-110	CASE,DFP C BLK	a
	O	AS1007	8Z-KC1-232-010	KEY,REMOVE -C	a
	O	AS1008	8Z-KC1-235-010	HLDR,REAR MTG	a
	O	AS1009	8Z-KC1-244-010	S-SCREW,5*6 TH+ TAPPING ST	a
	O	AS1010	8Z-KC1-250-010	S-SCREW,HEXAGON	a
	X	AS1011	8C-KCF-854-010	PAD,A	a
	X	AS1012	87-B50-079-010	LIST,FACILITY(B)-0007	a
	O	AS1013	8C-KCA-901-010	IB,YZ (9L)F R227	a
	O	AS1014	8C-KCG-913-010	IB,INST YZ,YV (9L,R)F	a

# ELECTRICAL PARTS LIST -1/10

! =  $\Delta$ SAFTY PARTS  
 C = Components marked

All components used on this model at the production line are shown in this service manual.

However, please note that not all components will be available as spare parts for after-sales service.

Components marked S and O are designated as spare parts for service and will be stocked at the spare parts centers.

Components marked X and R are not designated as spare parts for after sales service, and will not be stocked at the spare parts centers.

UNIT-NAME	! C	REF-NO	PARTS-NO	PARTS-NAME	SUFFIX&MODEL
					CDC-R227 YZSF
CD	O C	0201	87-010-552-040	CAP,E 22-16 M 5L SRE	a
CD	O C	0202	87-012-286-080	C-CAP,U 0.01-25 K B GRM	a
CD	O C	0203	87-A10-189-040	CAP,E 220-10 M 5L	a
CD	O C	0221	87-012-286-080	C-CAP,U 0.01-25 K B GRM	a
CD	O C	0222	87-012-286-080	C-CAP,U 0.01-25 K B GRM	a
CD	O C	0223	87-012-337-080	C-CAP,U 56P-50 J CH GRM	a
CD	O C	0224	87-012-162-080	C-CAP,U 1P-50 C CH GRM	a
CD	O C	0225	87-A10-260-080	C-CAP,U 0.1-16 K B	a
CD	O C	0226	87-010-555-040	CAP,E 100-10 M 5L SRE	a
CD	O C	0227	87-012-286-080	C-CAP,U 0.01-25 K B GRM	a
CD	O C	0228	87-A10-260-080	C-CAP,U 0.1-16 K B	a
CD	O C	0229	87-A10-353-080	C-CAP,U 0.22-10 K B	a
CD	O C	0230	87-A10-353-080	C-CAP,U 0.22-10 K B	a
CD	O C	0232	87-012-286-080	C-CAP,U 0.01-25 K B GRM	a
CD	O C	0233	87-010-555-040	CAP,E 100-10 M 5L SRE	a
CD	O C	0234	87-010-555-040	CAP,E 100-10 M 5L SRE	a
CD	O C	0235	87-010-555-040	CAP,E 100-10 M 5L SRE	a
CD	O C	0237	87-012-285-080	C-CAP,U 8200P-50 K B GRM	a
CD	O C	0241	87-010-555-040	CAP,E 100-10 M 5L SRE	a
CD	O C	0242	87-010-555-040	CAP,E 100-10 M 5L SRE	a
					CDC-R227 YZSF
CD	O C	0245	87-012-270-080	C-CAP,U 470P-50 K B GRM	a
CD	O C	0246	87-012-270-080	C-CAP,U 470P-50 K B GRM	a
CD	O C	0247	87-A10-504-080	C-CAP,U 0.047-16 K B	a
CD	O C	0248	87-012-286-080	C-CAP,U 0.01-25 K B GRM	a
CD	O C	0250	87-010-555-040	CAP,E 100-10 M 5L SRE	a
CD	O C	0251	87-010-555-040	CAP,E 100-10 M 5L SRE	a
CD	O C	0252	87-012-274-080	C-CAP,U 1000P-50 K B GRM	a
CD	O C	0253	87-012-274-080	C-CAP,U 1000P-50 K B GRM	a
CD	O C	0254	87-012-274-080	C-CAP,U 1000P-50 K B GRM	a
CD	O C	0258	87-A10-504-080	C-CAP,U 0.047-16 K B	a
CD	O C	0259	87-A10-504-080	C-CAP,U 0.047-16 K B	a
CD	O C	0260	87-A10-504-080	C-CAP,U 0.047-16 K B	a
CD	O C	0261	87-012-282-080	C-CAP,U 4700P-50 K B GRM	a
CD	O C	0262	87-012-279-080	C-CAP,U 2700P-50 K B GRM	a
CD	O C	0263	87-012-286-080	C-CAP,U 0.01-25 K B GRM	a
CD	O C	0264	87-010-785-080	C-CAP,U 0.015-25 K B GRM	a
CD	O C	0265	87-010-553-040	CAP,E 47-16 M 5L SRE	a
CD	O C	0268	87-012-188-080	C-CAP,U 47P-50 J CH GRM	a
CD	O C	0269	87-010-553-040	CAP,E 47-16 M 5L SRE	a
CD	O C	0270	87-010-553-040	CAP,E 47-16 M 5L SRE	a
					CDC-R227 YZSF
CD	O C	0271	87-012-286-080	C-CAP,U 0.01-25 K B GRM	a
CD	O C	0272	87-012-195-080	C-CAP,U 100P-50 J CH GRM	a
CD	O C	0273	87-012-199-080	C-CAP,U 220P-50 J CH GRM	a
CD	O C	0274	87-012-199-080	C-CAP,U 220P-50 J CH GRM	a
CD	O C	0276	87-010-555-040	CAP,E 100-10 M 5L SRE	a
CD	O C	0278	87-010-555-040	CAP,E 100-10 M 5L SRE	a
CD	O C	0279	87-A10-260-080	C-CAP,U 0.1-16 K B	a
CD	O C	0281	87-012-275-080	C-CAP,U 1200P-50 K B GRM	a
CD	O C	0282	87-012-275-080	C-CAP,U 1200P-50 K B GRM	a
CD	O C	0283	87-010-498-040	CAP,E 10-16 M 5L SRE	a
CD	O C	0284	87-010-498-040	CAP,E 10-16 M 5L SRE	a
CD	O C	0298	87-010-555-040	CAP,E 100-10 M 5L SRE	a
CD	O C	0299	87-012-195-080	C-CAP,U 100P-50 J CH GRM	a
CD	O CON	0201	87-A61-220-080	C-CONN,20P H 52271-2090	a
CD	S IC	0201	87-A22-080-040	C-IC,LA6557H	a
CD	S IC	0221	87-A22-081-040	C-IC,TA2153FN	a
CD	S IC	0241	8C-ZA5-611-030	C-IC,TC94A09F-301	a
CD	X JR	0102	88-108-000-080	C-JUMPER,U	a
CD	X JR	0201	88-108-000-080	C-JUMPER,U	a
CD	X JR	0203	88-108-000-080	C-JUMPER,U	a
					CDC-R227 YZSF
CD	O L	0221	87-003-102-080	COIL,10UH J LAL02	a
CD	O L	0241	87-003-143-080	COIL,4.7UH K LAL02	a
CD	O L	0242	87-003-143-080	COIL,4.7UH K LAL02	a
CD	S Q	0201	87-A30-299-080	TR,2SB1326	a
CD	S Q	0202	87-A30-287-040	C-TR,DTC114TKA	a
CD	S Q	0221	87-A30-289-040	C-TR,2SA1037AK(Q)	a
CD	X R	0201	88-108-000-080	C-JUMPER,U	a
CD	X R	0202	88-108-683-080	C-RES,U 68K-1/16W J	a
CD	O R	0203	88-108-822-080	C-RES,U 8.2K-1/16W J	a
CD	O R	0204	88-108-822-080	C-RES,U 8.2K-1/16W J	a
CD	X R	0205	88-108-000-080	C-JUMPER,U	a
CD	X R	0206	88-108-561-080	C-RES,U 560-1/16W J	a
CD	X R	0207	88-108-000-080	C-JUMPER,U	a
CD	O R	0208	88-108-101-080	C-RES,U 100-1/16W J	a
CD	O R	0209	88-108-562-080	C-RES,U 5.6K-1/16W J	a
CD	X R	0210	88-108-000-080	C-JUMPER,U	a
CD	X R	0211	88-108-820-080	C-RES,U 82-1/16W J	a
CD	X R	0212	88-108-393-080	C-RES,U 39K-1/16W J	a
CD	X R	0213	88-108-000-080	C-JUMPER,U	a
CD	X R	0214	88-108-000-080	C-JUMPER,U	a



# ELECTRICAL PARTS LIST -2/10

! =  $\Delta$  SAFTY PARTS  
 C = Components marked

All components used on this model at the production line are shown in this service manual.

However, please note that not all components will be available as spare parts for after-sales service.

Components marked S and O are designated as spare parts for service and will be stocked at the spare parts centers.

Components marked X and R are not designated as spare parts for after sales service, and will not be stocked at the spare parts centers.

UNIT-NAME	! C	REF-NO	PARTS-NO	PARTS-NAME	SUFFIX&MODEL
					CDC-R227 YZSF
CD	X R	0215	88-108-154-080	C-RES,U 150K-1/16W J	a
CD	O R	0221	88-108-102-080	C-RES,U 1K-1/16W J	a
CD	X R	0222	88-108-683-080	C-RES,U 68K-1/16W J	a
CD	O R	0223	88-108-473-080	C-RES,U 47K-1/16W J	a
CD	X R	0224	88-108-222-080	C-RES,U 2.2K-1/16W J	a
CD	X R	0225	88-108-221-080	C-RES,U 220-1/16W J	a
CD	X R	0226	88-108-000-080	C-JUMPER,U	a
CD	X R	0227	88-108-104-080	C-RES,U 100K-1/16W J	a
CD	O R	0228	88-108-103-080	C-RES,U 10K-1/16W J	a
CD	O R	0229	88-108-103-080	C-RES,U 10K-1/16W J	a
CD	O R	0230	88-108-103-080	C-RES,U 10K-1/16W J	a
CD	O R	0231	88-108-563-080	C-RES,U 56K-1/16W J	a
CD	O R	0232	88-108-563-080	C-RES,U 56K-1/16W J	a
CD	O R	0233	88-108-563-080	C-RES,U 56K-1/16W J	a
CD	O R	0234	88-108-563-080	C-RES,U 56K-1/16W J	a
CD	X R	0235	88-108-273-080	C-RES,U 27K-1/16W J	a
CD	X R	0236	88-108-273-080	C-RES,U 27K-1/16W J	a
CD	X R	0237	88-108-683-080	C-RES,U 68K-1/16W J	a
CD	O R	0238	88-108-102-080	C-RES,U 1K-1/16W J	a
CD	X R	0239	88-108-000-080	C-JUMPER,U	a
					CDC-R227 YZSF
CD	X R	0240	88-118-100-080	C-RES,S 10-1/10W J	a
CD	O R	0241	88-108-101-080	C-RES,U 100-1/16W J	a
CD	X R	0243	88-108-000-080	C-JUMPER,U	a
CD	X R	0244	88-108-333-080	C-RES,U 33K-1/16W J	a
CD	X R	0245	88-108-474-080	C-RES,U 470K-1/16W J	a
CD	O R	0246	88-108-473-080	C-RES,U 47K-1/16W J	a
CD	O R	0247	88-108-103-080	C-RES,U 10K-1/16W J	a
CD	O R	0249	88-108-102-080	C-RES,U 1K-1/16W J	a
CD	O R	0250	88-108-102-080	C-RES,U 1K-1/16W J	a
CD	X R	0251	88-108-000-080	C-JUMPER,U	a
CD	O R	0253	88-108-103-080	C-RES,U 10K-1/16W J	a
CD	X R	0254	88-108-474-080	C-RES,U 470K-1/16W J	a
CD	X R	0255	88-108-474-080	C-RES,U 470K-1/16W J	a
CD	X R	0256	88-108-104-080	C-RES,U 100K-1/16W J	a
CD	X R	0281	88-108-222-080	C-RES,U 2.2K-1/16W J	a
CD	X R	0282	88-108-222-080	C-RES,U 2.2K-1/16W J	a
CD	X R	0298	88-108-472-080	C-RES,U 4.7K-1/16W J	a
CD	X R	0299	88-108-472-080	C-RES,U 4.7K-1/16W J	a
CD	O X	0241	87-A70-376-080	VIB,CER 16.934MHZ CSTLS16M9X55	a
FRONT	O C	0601	87-A10-047-080	C-CAP,U 1-10 Z F	a
					CDC-R227 YZSF
FRONT	O C	0602	87-A10-504-080	C-CAP,U 0.047-16 K B	a
FRONT	O C	0603	87-A10-504-080	C-CAP,U 0.047-16 K B	a
FRONT	O C	0604	87-012-273-080	C-CAP,U 820P-50 K B GRM	a
FRONT	O C	0605	87-A10-260-080	C-CAP,U 0.1-16 K B	a
FRONT	O C	0621	87-012-274-080	C-CAP,U 1000P-50 K B GRM	a
FRONT	O C	0622	87-012-274-080	C-CAP,U 1000P-50 K B GRM	a
FRONT	O CON	0601	88-KTA-602-010	C-CONN,15P CAM-B67	a
FRONT	S D	0601	87-A40-817-040	C-ZENER,STZ6.8N	a
FRONT	S D	0602	87-A40-817-040	C-ZENER,STZ6.8N	a
FRONT	S IC	0601	88-KT1-608-010	C-IC,LC75854W	a
FRONT	O J	0601	85-HRL-623-010	JACK,3.5 BLK ST BLK	a
FRONT	O LCD	0601	8C-KCA-620-010	LCD,CKC-A	a
FRONT	O LED	0641	87-A91-355-040	C-LED,BR1112H-TR-RED	a
FRONT	O LED	0642	87-A91-355-040	C-LED,BR1112H-TR-RED	a
FRONT	O LED	0643	87-A91-355-040	C-LED,BR1112H-TR-RED	a
FRONT	O LED	0651	87-A91-355-040	C-LED,BR1112H-TR-RED	a
FRONT	O LED	0652	87-A91-355-040	C-LED,BR1112H-TR-RED	a
FRONT	O LED	0653	87-A91-355-040	C-LED,BR1112H-TR-RED	a
FRONT	O LED	0661	87-A41-085-010	LED,NSPW315BS WHT	a
FRONT	O LED	0671	87-A41-118-040	C-LED,SEC1E01C-1 BLU	a
					CDC-R227 YZSF
FRONT	O LED	0672	87-A41-118-040	C-LED,SEC1E01C-1 BLU	a
FRONT	O LED	0673	87-A41-118-040	C-LED,SEC1E01C-1 BLU	a
FRONT	S Q	0651	89-324-122-040	C-TR,2SC2412KR	a
FRONT	S Q	0661	89-324-122-040	C-TR,2SC2412KR	a
FRONT	S Q	0671	89-324-122-040	C-TR,2SC2412KR	a
FRONT	O R	0601	88-108-103-080	C-RES,U 10K-1/16W J	a
FRONT	O R	0602	88-108-103-080	C-RES,U 10K-1/16W J	a
FRONT	O R	0603	88-108-103-080	C-RES,U 10K-1/16W J	a
FRONT	X R	0604	88-108-683-080	C-RES,U 68K-1/16W J	a
FRONT	O R	0605	88-108-102-080	C-RES,U 1K-1/16W J	a
FRONT	O R	0606	88-108-102-080	C-RES,U 1K-1/16W J	a
FRONT	O R	0607	88-108-102-080	C-RES,U 1K-1/16W J	a
FRONT	O R	0608	88-108-102-080	C-RES,U 1K-1/16W J	a
FRONT	O R	0609	88-108-102-080	C-RES,U 1K-1/16W J	a
FRONT	O R	0610	88-108-103-080	C-RES,U 10K-1/16W J	a
FRONT	X R	0621	88-108-104-080	C-RES,U 100K-1/16W J	a
FRONT	X R	0622	88-108-104-080	C-RES,U 100K-1/16W J	a
FRONT	X R	0641	88-108-391-080	C-RES,U 390-1/16W J	a
FRONT	X R	0651	88-108-561-080	C-RES,U 560-1/16W J	a
FRONT	X R	0652	88-108-561-080	C-RES,U 560-1/16W J	a

# ELECTRICAL PARTS LIST -3/10

! =  $\Delta$  SAFTY PARTS  
 C = Components marked

All components used on this model at the production line are shown in this service manual.

However, please note that not all components will be available as spare parts for after-sales service.

Components marked S and O are designated as spare parts for service and will be stocked at the spare parts centers.

Components marked X and R are not designated as spare parts for after sales service, and will not be stocked at the spare parts centers.

UNIT-NAME	! C	REF-NO	PARTS-NO	PARTS-NAME	SUFFIX&MODEL
					CDC-R227 YZSF
FRONT	X R	0653	88-108-561-080	C-RES,U 560-1/16W J	a
FRONT	X R	0654	88-108-682-080	C-RES,U 6.8K-1/16W J	a
FRONT	X R	0661	88-118-331-080	C-RES,S 330-1/10W J	a
FRONT	X R	0662	88-108-682-080	C-RES,U 6.8K-1/16W J	a
FRONT	O R	0663	88-108-102-080	C-RES,U 1K-1/16W J	a
FRONT	X R	0671	88-108-391-080	C-RES,U 390-1/16W J	a
FRONT	X R	0672	88-108-391-080	C-RES,U 390-1/16W J	a
FRONT	X R	0673	88-108-391-080	C-RES,U 390-1/16W J	a
FRONT	X R	0674	88-108-682-080	C-RES,U 6.8K-1/16W J	a
FRONT	O SW	0601	87-A90-164-080	SW,TACT SKQNAB (N)	a
FRONT	O SW	0602	87-A90-164-080	SW,TACT SKQNAB (N)	a
FRONT	O SW	0603	87-A90-164-080	SW,TACT SKQNAB (N)	a
FRONT	O SW	0604	87-A91-987-080	SW,TACT SKQCAB	a
FRONT	O SW	0605	87-A91-987-080	SW,TACT SKQCAB	a
FRONT	O SW	0606	87-A91-987-080	SW,TACT SKQCAB	a
FRONT	O SW	0607	87-A90-164-080	SW,TACT SKQNAB (N)	a
FRONT	O SW	0608	87-A91-987-080	SW,TACT SKQCAB	a
FRONT	O SW	0609	87-036-339-080	C-SW,TACT SKQM	a
FRONT	O SW	0610	87-A91-987-080	SW,TACT SKQCAB	a
FRONT	O SW	0611	87-036-339-080	C-SW,TACT SKQM	a
					CDC-R227 YZSF
FRONT	O SW	0612	87-A90-164-080	SW,TACT SKQNAB (N)	a
FRONT	O SW	0613	87-A90-164-080	SW,TACT SKQNAB (N)	a
FRONT	O SW	0614	87-A90-164-080	SW,TACT SKQNAB (N)	a
FRONT	O SW	0615	87-A90-164-080	SW,TACT SKQNAB (N)	a
FRONT	O SW	0616	87-A90-164-080	SW,TACT SKQNAB (N)	a
FRONT	O SW	0617	87-A91-987-080	SW,TACT SKQCAB	a
FRONT	O SW	0621	87-A92-329-010	SW,RTRY SRP-1211VD	a
MAIN	O ANT	0101	8Z-KT1-614-010	ANT,AW-002	a
MAIN	O C	0101	87-012-274-080	C-CAP,U 1000P-50 K B GRM	a
MAIN	O C	0102	87-012-286-080	C-CAP,U 0.01-25 K B GRM	a
MAIN	O C	0103	87-012-274-080	C-CAP,U 1000P-50 K B GRM	a
MAIN	O C	0104	87-012-282-080	C-CAP,U 4700P-50 K B GRM	a
MAIN	O C	0105	87-010-490-040	CAP,E 0.1-50 M 5L MA	a
MAIN	O C	0107	87-010-380-040	CAP,E 47-16 M 11L SME	a
MAIN	O C	0108	87-012-195-080	C-CAP,U 100P-50 J CH GRM	a
MAIN	O C	0109	87-012-286-080	C-CAP,U 0.01-25 K B GRM	a
MAIN	O C	0110	87-010-380-040	CAP,E 47-16 M 11L SME	a
MAIN	O C	0111	87-010-759-080	C-CAP,U 0.1-25 Z F CM/CB	a
MAIN	O C	0112	87-012-286-080	C-CAP,U 0.01-25 K B GRM	a
MAIN	O C	0113	87-010-759-080	C-CAP,U 0.1-25 Z F CM/CB	a
					CDC-R227 YZSF
MAIN	O C	0115	87-012-274-080	C-CAP,U 1000P-50 K B GRM	a
MAIN	O C	0116	87-012-286-080	C-CAP,U 0.01-25 K B GRM	a
MAIN	O C	0117	87-010-787-080	C-CAP,U 0.022-25 K B GRM	a
MAIN	O C	0118	87-012-286-080	C-CAP,U 0.01-25 K B GRM	a
MAIN	O C	0119	87-010-402-040	CAP,E 2.2-50 M 11L SME	a
MAIN	O C	0120	87-012-281-080	C-CAP,U 3900P-50 K B GRM	a
MAIN	O C	0121	87-010-786-080	C-CAP,U 0.018-25 K B GRM	a
MAIN	O C	0122	87-010-786-080	C-CAP,U 0.018-25 K B GRM	a
MAIN	O C	0123	87-A10-707-080	C-CAP,U 0.47-10 Z F	a
MAIN	O C	0124	87-A10-707-080	C-CAP,U 0.47-10 Z F	a
MAIN	O C	0125	87-010-379-040	CAP,E 22-16 M 11L SME	a
MAIN	O C	0151	87-012-183-080	C-CAP,U 30P-50 J CH GRM	a
MAIN	O C	0152	87-012-182-080	C-CAP,U 27P-50 J CH GRM	a
MAIN	O C	0153	87-010-495-040	CAP,E 2.2-50 M 5L SRE	a
MAIN	O C	0154	87-012-268-080	C-CAP,U 330P-50 K B GRM	a
MAIN	O C	0155	87-012-271-080	C-CAP,U 560P-50 K B GRM	a
MAIN	O C	0156	87-010-759-080	C-CAP,U 0.1-25 Z F CM/CB	a
MAIN	O C	0157	87-010-380-040	CAP,E 47-16 M 11L SME	a
MAIN	O C	0401	87-010-401-040	CAP,E 1-50 M 11L SME	a
MAIN	O C	0402	87-010-498-040	CAP,E 10-16 M 5L SRE	a
					CDC-R227 YZSF
MAIN	O C	0403	87-A10-047-080	C-CAP,U 1-10 Z F	a
MAIN	O C	0405	87-012-280-080	C-CAP,U 3300P-50 K B GRM	a
MAIN	O C	0406	87-012-280-080	C-CAP,U 3300P-50 K B GRM	a
MAIN	O C	0407	87-010-787-080	C-CAP,U 0.022-25 K B GRM	a
MAIN	O C	0408	87-010-787-080	C-CAP,U 0.022-25 K B GRM	a
MAIN	O C	0409	87-010-498-040	CAP,E 10-16 M 5L SRE	a
MAIN	O C	0410	87-010-498-040	CAP,E 10-16 M 5L SRE	a
MAIN	O C	0411	87-A10-781-080	C-CAP,U 0.15-10 K B	a
MAIN	O C	0412	87-A10-781-080	C-CAP,U 0.15-10 K B	a
MAIN	O C	0413	87-A10-781-080	C-CAP,U 0.15-10 K B	a
MAIN	O C	0414	87-A10-781-080	C-CAP,U 0.15-10 K B	a
MAIN	O C	0415	87-010-498-040	CAP,E 10-16 M 5L SRE	a
MAIN	O C	0416	87-010-498-040	CAP,E 10-16 M 5L SRE	a
MAIN	O C	0417	87-010-759-080	C-CAP,U 0.1-25 Z F CM/CB	a
MAIN	O C	0418	87-010-498-040	CAP,E 10-16 M 5L SRE	a
MAIN	O C	0419	87-010-498-040	CAP,E 10-16 M 5L SRE	a
MAIN	O C	0421	87-010-555-040	CAP,E 100-10 M 5L SRE	a
MAIN	O C	0422	87-010-787-080	C-CAP,U 0.022-25 K B GRM	a
MAIN	O C	0431	87-010-498-040	CAP,E 10-16 M 5L SRE	a
MAIN	O C	0432	87-010-498-040	CAP,E 10-16 M 5L SRE	a



# ELECTRICAL PARTS LIST -4/10

! = SAFETY PARTS  
C = Components marked

All components used on this model at the production line are shown in this service manual.

However, please note that not all components will be available as spare parts for after-sales service.

Components marked S and O are designated as spare parts for service and will be stocked at the spare parts centers.

Components marked X and R are not designated as spare parts for after sales service, and will not be stocked at the spare parts centers.

UNIT-NAME	! C	REF-NO	PARTS-NO	PARTS-NAME	SUFFIX&MODEL
					CDC-R227 YZSF
MAIN	O C	0433	87-010-498-040	CAP,E 10-16 M 5L SRE	a
MAIN	O C	0434	87-010-498-040	CAP,E 10-16 M 5L SRE	a
MAIN	O C	0439	87-010-498-040	CAP,E 10-16 M 5L SRE	a
MAIN	O C	0440	87-010-498-040	CAP,E 10-16 M 5L SRE	a
MAIN	O C	0442	87-012-270-080	C-CAP,U 470P-50 K B GRM	a
MAIN	O C	0444	87-012-270-080	C-CAP,U 470P-50 K B GRM	a
MAIN	O C	0451	87-A10-707-080	C-CAP,U 0.47-10 Z F	a
MAIN	O C	0452	87-A10-707-080	C-CAP,U 0.47-10 Z F	a
MAIN	O C	0453	87-A10-707-080	C-CAP,U 0.47-10 Z F	a
MAIN	O C	0454	87-012-286-080	C-CAP,U 0.01-25 K B GRM	a
MAIN	O C	0455	87-010-498-040	CAP,E 10-16 M 5L SRE	a
MAIN	O C	0456	87-A10-047-080	C-CAP,U 1-10 Z F	a
MAIN	O C	0501	87-010-805-080	C-CAP,S 1-16 Z F GRM	a
MAIN	O C	0502	87-010-805-080	C-CAP,S 1-16 Z F GRM	a
MAIN	O C	0503	87-010-805-080	C-CAP,S 1-16 Z F GRM	a
MAIN	O C	0504	87-010-805-080	C-CAP,S 1-16 Z F GRM	a
MAIN	O C	0505	87-012-271-080	C-CAP,U 560P-50 K B GRM	a
MAIN	O C	0506	87-012-271-080	C-CAP,U 560P-50 K B GRM	a
MAIN	O C	0507	87-012-271-080	C-CAP,U 560P-50 K B GRM	a
MAIN	O C	0508	87-012-271-080	C-CAP,U 560P-50 K B GRM	a
					CDC-R227 YZSF
MAIN	O C	0509	87-010-497-040	CAP,E 4.7-35 M 5L SRE	a
MAIN	O C	0510	87-010-380-040	CAP,E 47-16 M 11L SME	a
MAIN	O C	0511	87-A12-317-080	C-CAP,U 0.1-50 Z F	a
MAIN	O C	0512	87-A12-317-080	C-CAP,U 0.1-50 Z F	a
MAIN	O C	0513	87-A12-317-080	C-CAP,U 0.1-50 Z F	a
MAIN	O C	0514	87-A12-317-080	C-CAP,U 0.1-50 Z F	a
MAIN	O C	0515	87-010-805-080	C-CAP,S 1-16 Z F GRM	a
MAIN	O C	0516	87-A12-317-080	C-CAP,U 0.1-50 Z F	a
MAIN	O C	0517	8A-KC7-623-000	CAP,E 2200-16 125 BT	a
MAIN	O C	0519	87-010-497-040	CAP,E 4.7-35 M 5L SRE	a
MAIN	O C	0521	87-A12-317-080	C-CAP,U 0.1-50 Z F	a
MAIN	O C	0526	87-010-495-040	CAP,E 2.2-50 M 5L SRE	a
MAIN	O C	0702	87-012-278-080	C-CAP,U 2200P-50 K B GRM	a
MAIN	O C	0703	87-012-278-080	C-CAP,U 2200P-50 K B GRM	a
MAIN	O C	0705	87-010-759-080	C-CAP,U 0.1-25 Z F CM/CB	a
MAIN	O C	0706	87-010-759-080	C-CAP,U 0.1-25 Z F CM/CB	a
MAIN	O C	0707	87-010-495-040	CAP,E 2.2-50 M 5L SRE	a
MAIN	O C	0708	87-010-495-040	CAP,E 2.2-50 M 5L SRE	a
MAIN	O C	0709	87-010-805-080	C-CAP,S 1-16 Z F GRM	a
MAIN	O C	0710	87-010-805-080	C-CAP,S 1-16 Z F GRM	a
					CDC-R227 YZSF
MAIN	O C	0731	87-010-498-040	CAP,E 10-16 M 5L SRE	a
MAIN	O C	0804	87-010-498-040	CAP,E 10-16 M 5L SRE	a
MAIN	O C	0805	87-010-380-040	CAP,E 47-16 M 11L SME	a
MAIN	O C	0806	87-010-787-080	C-CAP,U 0.022-25 K B GRM	a
MAIN	O C	0807	87-010-759-080	C-CAP,U 0.1-25 Z F CM/CB	a
MAIN	O C	0808	87-010-759-080	C-CAP,U 0.1-25 Z F CM/CB	a
MAIN	O C	0809	87-010-759-080	C-CAP,U 0.1-25 Z F CM/CB	a
MAIN	O C	0811	87-010-787-080	C-CAP,U 0.022-25 K B GRM	a
MAIN	O C	0816	87-010-787-080	C-CAP,U 0.022-25 K B GRM	a
MAIN	O C	0819	87-012-278-080	C-CAP,U 2200P-50 K B GRM	a
MAIN	O C	0820	87-010-380-040	CAP,E 47-16 M 11L SME	a
MAIN	O C	0852	87-012-278-080	C-CAP,U 2200P-50 K B GRM	a
MAIN	O C	0912	87-010-759-080	C-CAP,U 0.1-25 Z F CM/CB	a
MAIN	O C	0913	87-010-759-080	C-CAP,U 0.1-25 Z F CM/CB	a
MAIN	O C	0914	87-010-759-080	C-CAP,U 0.1-25 Z F CM/CB	a
MAIN	O C	0921	87-010-759-080	C-CAP,U 0.1-25 Z F CM/CB	a
MAIN	O C	0923	87-010-759-080	C-CAP,U 0.1-25 Z F CM/CB	a
MAIN	O C	0924	87-010-154-080	C-CAP,S 10P-50 D CH GRM	a
MAIN	O C	0925	87-010-154-080	C-CAP,S 10P-50 D CH GRM	a
MAIN	O C	0927	87-012-195-080	C-CAP,U 100P-50 J CH GRM	a
					CDC-R227 YZSF
MAIN	O C	0928	87-012-195-080	C-CAP,U 100P-50 J CH GRM	a
MAIN	O C	0929	87-A10-707-080	C-CAP,U 0.47-10 Z F	a
MAIN	O C	0930	87-012-274-080	C-CAP,U 1000P-50 K B GRM	a
MAIN	O C	0931	87-012-199-080	C-CAP,U 220P-50 J CH GRM	a
MAIN	O C	0932	87-012-278-080	C-CAP,U 2200P-50 K B GRM	a
MAIN	O C	0933	87-016-039-090	CAP,DL 0.022F-5.5 Z 70 FM	a
MAIN	O C	0934	87-012-195-080	C-CAP,U 100P-50 J CH GRM	a
MAIN	O	CNA0801	8A-KT1-646-010	CONN ASSY,8P ISO-WHITE-B	X a
MAIN	O	CNA0802	8A-KT1-645-010	CONN ASSY,8P ISO-BLACK-B	X a
MAIN	O	CON0701	87-A61-219-010	CONN,20P H 52089-2020	a
MAIN	O	CON0702	88-KTA-603-010	CONN,15P CAM-B68	a
MAIN	S D	0101	87-A40-250-040	C-DIODE,DAN217	a
MAIN	S D	0151	87-070-136-080	ZENER,MTZJ5.1B	a
MAIN	S D	0401	87-020-331-040	C-DIODE,DAN202K	a
MAIN	S D	0402	87-020-465-080	DIODE,1SS133	a
MAIN	X D	0403	88-121-101-080	RES,100-1/8W J	a
MAIN	S D	0451	87-A40-250-040	C-DIODE,DAN217	a
MAIN	S D	0501	87-001-783-080	DIODE,1N4002	a
MAIN	S D	0502	87-001-783-080	DIODE,1N4002	a
MAIN	S D	0503	87-001-783-080	DIODE,1N4002	a

# ELECTRICAL PARTS LIST -5/10

! =  $\Delta$  SAFTY PARTS  
 C = Components marked

All components used on this model at the production line are shown in this service manual.

However, please note that not all components will be available as spare parts for after-sales service.

Components marked S and O are designated as spare parts for service and will be stocked at the spare parts centers.

Components marked X and R are not designated as spare parts for after sales service, and will not be stocked at the spare parts centers.

UNIT-NAME	! C	REF-NO	PARTS-NO	PARTS-NAME	SUFFIX&MODEL
					CDC-R227 YZSF
MAIN		S D	0504 87-001-783-080	DIODE,1N4002	a
MAIN		S D	0505 87-001-783-080	DIODE,1N4002	a
MAIN		S D	0506 87-001-783-080	DIODE,1N4002	a
MAIN		S D	0507 87-001-783-080	DIODE,1N4002	a
MAIN		S D	0508 87-001-783-080	DIODE,1N4002	a
MAIN		S D	0522 87-070-334-080	ZENER,MTZJ10B	a
MAIN		S D	0523 87-020-465-080	DIODE,1SS133	a
MAIN		S D	0705 87-A40-337-080	ZENER,MTZJ6.8B	a
MAIN		S D	0706 87-A40-337-080	ZENER,MTZJ6.8B	a
MAIN		S D	0707 87-A40-337-080	ZENER,MTZJ6.8B	a
MAIN		S D	0708 87-A40-337-080	ZENER,MTZJ6.8B	a
MAIN		S D	0709 87-A40-337-080	ZENER,MTZJ6.8B	a
MAIN		S D	0710 87-A40-337-080	ZENER,MTZJ6.8B	a
MAIN		S D	0711 87-A40-337-080	ZENER,MTZJ6.8B	a
MAIN		S D	0712 87-A40-337-080	ZENER,MTZJ6.8B	a
MAIN		S D	0713 87-A40-337-080	ZENER,MTZJ6.8B	a
MAIN		S D	0777 87-020-331-040	C-DIODE,DAN202K	a
MAIN		S D	0801 87-070-334-080	ZENER,MTZJ10B	a
MAIN		S D	0802 87-020-331-040	C-DIODE,DAN202K	a
MAIN		S D	0804 87-A40-523-080	ZENER,MTZJ9.1B	a
					CDC-R227 YZSF
MAIN		S D	0805 87-017-932-080	ZENER,MTZJ6.2B	a
MAIN		S D	0806 87-020-330-040	C-DIODE,DAP202K	a
MAIN		S D	0851 87-A40-798-010	DIODE,1N5402 (3A/200V)	a
MAIN		S D	0903 87-020-465-080	DIODE,1SS133	a
MAIN		S D	0906 87-020-465-080	DIODE,1SS133	a
MAIN		S D	0907 87-070-136-080	ZENER,MTZJ5.1B	a
MAIN		S D	0910 87-070-136-080	ZENER,MTZJ5.1B	a
MAIN		S D	0911 87-A40-620-080	ZENER,MTZJ6.2A	a
MAIN		S D	0912 87-070-136-080	ZENER,MTZJ5.1B	a
MAIN		! S F	0901 8B-KC1-621-010	FUSE,15A 32V	a
MAIN		S IC	0151 88-KT1-607-080	C-IC, SAA6579T	a
MAIN		S IC	0401 8Z-KT1-622-010	C-IC, LC75374E	a
MAIN		S IC	0501 87-A22-157-010	IC, LA4743J	a
MAIN		S IC	0901 8C-KCA-611-030	C-IC, UPD178078GF-566-3BA	a
MAIN		S IC	0902 88-KT1-606-080	IC, PST994D	a
MAIN		O J	0401 87-A61-225-110	JACK, PIN 2P XR-401	a
MAIN		X JR	0101 88-118-000-080	C-JUMPER, S	a
MAIN		X JR	0102 88-118-000-080	C-JUMPER, S	a
MAIN		X JR	0103 88-118-000-080	C-JUMPER, S	a
MAIN		X JR	0104 88-118-000-080	C-JUMPER, S	a
					CDC-R227 YZSF
MAIN		X JR	0105 88-118-000-080	C-JUMPER, S	a
MAIN		X JR	0106 88-118-000-080	C-JUMPER, S	a
MAIN		X JR	0108 88-118-000-080	C-JUMPER, S	a
MAIN		X JR	0109 88-118-000-080	C-JUMPER, S	a
MAIN		X JR	0110 88-118-000-080	C-JUMPER, S	a
MAIN		X JR	0111 88-118-000-080	C-JUMPER, S	a
MAIN		X JR	0113 88-118-000-080	C-JUMPER, S	a
MAIN		X JR	0114 88-118-000-080	C-JUMPER, S	a
MAIN		X JR	0115 88-118-000-080	C-JUMPER, S	a
MAIN		X JR	0116 88-118-000-080	C-JUMPER, S	a
MAIN		X JR	0117 88-118-000-080	C-JUMPER, S	a
MAIN		X JR	0118 88-118-000-080	C-JUMPER, S	a
MAIN		X JR	0120 88-118-000-080	C-JUMPER, S	a
MAIN		X JR	0127 88-118-000-080	C-JUMPER, S	a
MAIN		X JR	0129 88-118-000-080	C-JUMPER, S	a
MAIN		X JR	0501 88-129-000-080	C-JUMPER, 3216	a
MAIN		X JR	0502 88-129-000-080	C-JUMPER, 3216	a
MAIN		X JR	0503 88-129-000-080	C-JUMPER, 3216	a
MAIN		X JR	0504 88-129-000-080	C-JUMPER, 3216	a
MAIN		X JR	0505 88-129-000-080	C-JUMPER, 3216	a
					CDC-R227 YZSF
MAIN		X JR	0506 88-129-000-080	C-JUMPER, 3216	a
MAIN		X JR	0508 88-129-000-080	C-JUMPER, 3216	a
MAIN		X JR	0509 88-129-000-080	C-JUMPER, 3216	a
MAIN		X JR	0510 88-129-000-080	C-JUMPER, 3216	a
MAIN		X JR	0511 88-129-000-080	C-JUMPER, 3216	a
MAIN		X JR	0512 88-129-000-080	C-JUMPER, 3216	a
MAIN		X JR	0513 88-129-000-080	C-JUMPER, 3216	a
MAIN		X JR	0514 88-129-000-080	C-JUMPER, 3216	a
MAIN		X JR	0515 88-129-000-080	C-JUMPER, 3216	a
MAIN		X JR	0516 88-129-000-080	C-JUMPER, 3216	a
MAIN		X JR	0517 88-129-000-080	C-JUMPER, 3216	a
MAIN		X JR	0518 88-129-000-080	C-JUMPER, 3216	a
MAIN		X JR	0520 88-129-000-080	C-JUMPER, 3216	a
MAIN		X JR	0521 88-129-000-080	C-JUMPER, 3216	a
MAIN		X JR	0522 88-129-000-080	C-JUMPER, 3216	a
MAIN		X JR	0523 88-129-000-080	C-JUMPER, 3216	a
MAIN		X JR	0529 88-129-000-080	C-JUMPER, 3216	a
MAIN		X JR	0530 88-129-000-080	C-JUMPER, 3216	a
MAIN		X JW	0239 88-121-560-080	RES, 56-1/8W J	a
MAIN		O L	0101 87-003-143-080	COIL, 4.7UH K LAL02	a



# ELECTRICAL PARTS LIST -6/10

! =  $\Delta$  SAFTY PARTS  
 C = Components marked

All components used on this model at the production line are shown in this service manual.

However, please note that not all components will be available as spare parts for after-sales service.

Components marked S and O are designated as spare parts for service and will be stocked at the spare parts centers.

Components marked X and R are not designated as spare parts for after sales service, and will not be stocked at the spare parts centers.

UNIT-NAME	! C	REF-NO	PARTS-NO	PARTS-NAME	SUFFIX&MODEL
					CDC-R227 YZSF
MAIN		O L	0102 8Z-KT1-619-010	COIL,68MH K7-D	a
MAIN		O L	0401 87-003-102-080	COIL,10UH J LAL02	a
MAIN		O L	0701 87-005-906-080	C-COIL,S 10UH K LK2125	a
MAIN		O L	0702 87-003-102-080	COIL,10UH J LAL02	a
MAIN		O L	0851 8B-KCF-615-010	FLTR,AMORPHOUS -CHOKE	a
MAIN		O L	0901 87-003-149-080	COIL,47UH J LAL02	a
MAIN		S Q	0101 87-A30-287-040	C-TR,DTC114TKA	a
MAIN		S Q	0102 87-A30-289-040	C-TR,2SA1037AK(Q)	a
MAIN		S Q	0103 89-324-122-040	C-TR,2SC2412KR	a
MAIN		S Q	0105 89-324-122-040	C-TR,2SC2412KR	a
MAIN		S Q	0106 89-324-122-040	C-TR,2SC2412KR	a
MAIN		S Q	0108 89-324-122-040	C-TR,2SC2412KR	a
MAIN		S Q	0109 89-324-122-040	C-TR,2SC2412KR	a
MAIN		S Q	0401 87-A30-287-040	C-TR,DTC114TKA	a
MAIN		S Q	0402 87-A30-287-040	C-TR,DTC114TKA	a
MAIN		S Q	0403 87-A30-287-040	C-TR,DTC114TKA	a
MAIN		S Q	0404 87-A30-287-040	C-TR,DTC114TKA	a
MAIN		S Q	0405 87-A30-283-040	C-TR,DTA114YKA	a
MAIN		S Q	0406 87-A30-287-040	C-TR,DTC114TKA	a
MAIN		S Q	0451 89-324-122-040	C-TR,2SC2412KR	a
					CDC-R227 YZSF
MAIN		S Q	0501 87-A30-272-040	C-TR,DTA124EKA	a
MAIN		S Q	0801 89-213-750-010	TR,2SB1375	a
MAIN		S Q	0802 89-324-122-040	C-TR,2SC2412KR	a
MAIN		S Q	0803 89-324-122-040	C-TR,2SC2412KR	a
MAIN		S Q	0804 87-A30-287-040	C-TR,DTC114TKA	a
MAIN		S Q	0805 89-213-750-010	TR,2SB1375	a
MAIN		S Q	0806 89-420-120-010	TR,2SD2012	a
MAIN		S Q	0807 87-A30-289-040	C-TR,2SA1037AK(Q)	a
MAIN		S Q	0808 87-A30-287-040	C-TR,DTC114TKA	a
MAIN		O Q	0809 89-418-580-080	TR,2SD1858TV2	a
MAIN		X R	0101 88-108-105-080	C-RES,U 1M-1/16W J	a
MAIN		O R	0102 88-108-102-080	C-RES,U 1K-1/16W J	a
MAIN		X R	0103 88-108-472-080	C-RES,U 4.7K-1/16W J	a
MAIN		O R	0104 88-108-102-080	C-RES,U 1K-1/16W J	a
MAIN		O R	0105 88-108-102-080	C-RES,U 1K-1/16W J	a
MAIN		X R	0106 88-108-472-080	C-RES,U 4.7K-1/16W J	a
MAIN		X R	0107 88-118-100-080	C-RES,S 10-1/10W J	a
MAIN		X R	0108 88-108-181-080	C-RES,U 180-1/16W J	a
MAIN		O R	0109 88-108-103-080	C-RES,U 10K-1/16W J	a
MAIN		X R	0110 88-108-222-080	C-RES,U 2.2K-1/16W J	a
					CDC-R227 YZSF
MAIN		O R	0111 88-108-473-080	C-RES,U 47K-1/16W J	a
MAIN		O R	0112 88-108-473-080	C-RES,U 47K-1/16W J	a
MAIN		X R	0114 88-108-184-080	C-RES,U 180K-1/16W J	a
MAIN		O R	0115 88-108-102-080	C-RES,U 1K-1/16W J	a
MAIN		O R	0116 88-108-103-080	C-RES,U 10K-1/16W J	a
MAIN		X R	0117 88-108-821-080	C-RES,U 820-1/16W J	a
MAIN		O R	0118 88-108-223-080	C-RES,U 22K-1/16W J	a
MAIN		X R	0119 88-108-333-080	C-RES,U 33K-1/16W J	a
MAIN		O R	0120 88-108-473-080	C-RES,U 47K-1/16W J	a
MAIN		X R	0121 88-121-682-080	RES,6.8K-1/8W J	a
MAIN		X R	0122 88-121-682-080	RES,6.8K-1/8W J	a
MAIN		X R	0123 88-108-330-080	C-RES,U 33-1/16W J	a
MAIN		X R	0125 88-118-000-080	C-JUMPER,S	a
MAIN		X R	0128 88-121-331-080	RES,330-1/8W J	a
MAIN		X R	0129 88-118-000-080	C-JUMPER,S	a
MAIN		X R	0151 88-108-222-080	C-RES,U 2.2K-1/16W J	a
MAIN		O R	0401 88-108-562-080	C-RES,U 5.6K-1/16W J	a
MAIN		X R	0402 88-108-222-080	C-RES,U 2.2K-1/16W J	a
MAIN		O R	0403 88-108-332-080	C-RES,U 3.3K-1/16W J	a
MAIN		O R	0404 88-108-332-080	C-RES,U 3.3K-1/16W J	a
					CDC-R227 YZSF
MAIN		O R	0405 88-108-332-080	C-RES,U 3.3K-1/16W J	a
MAIN		O R	0406 88-108-332-080	C-RES,U 3.3K-1/16W J	a
MAIN		X R	0431 88-121-102-080	RES,1K-1/8W J	a
MAIN		X R	0432 88-121-102-080	RES,1K-1/8W J	a
MAIN		X R	0433 88-121-102-080	RES,1K-1/8W J	a
MAIN		X R	0434 88-121-102-080	RES,1K-1/8W J	a
MAIN		O R	0439 88-108-102-080	C-RES,U 1K-1/16W J	a
MAIN		O R	0440 88-108-102-080	C-RES,U 1K-1/16W J	a
MAIN		O R	0441 88-108-102-080	C-RES,U 1K-1/16W J	a
MAIN		O R	0442 88-108-102-080	C-RES,U 1K-1/16W J	a
MAIN		X R	0443 88-108-104-080	C-RES,U 100K-1/16W J	a
MAIN		X R	0444 88-108-104-080	C-RES,U 100K-1/16W J	a
MAIN		X R	0445 88-108-104-080	C-RES,U 100K-1/16W J	a
MAIN		X R	0446 88-108-104-080	C-RES,U 100K-1/16W J	a
MAIN		X R	0451 88-108-104-080	C-RES,U 100K-1/16W J	a
MAIN		X R	0452 88-108-104-080	C-RES,U 100K-1/16W J	a
MAIN		X R	0453 88-108-105-080	C-RES,U 1M-1/16W J	a
MAIN		X R	0454 88-108-472-080	C-RES,U 4.7K-1/16W J	a
MAIN		O R	0455 88-108-103-080	C-RES,U 10K-1/16W J	a
MAIN		O R	0456 88-108-102-080	C-RES,U 1K-1/16W J	a



# ELECTRICAL PARTS LIST -7/10

! =  $\Delta$  SAFTY PARTS  
 C = Components marked

All components used on this model at the production line are shown in this service manual.

However, please note that not all components will be available as spare parts for after-sales service.

Components marked S and O are designated as spare parts for service and will be stocked at the spare parts centers.

Components marked X and R are not designated as spare parts for after sales service, and will not be stocked at the spare parts centers.

UNIT-NAME	! C	REF-NO	PARTS-NO	PARTS-NAME	SUFFIX&MODEL
					CDC-R227 YZSF
MAIN	X R	0457	88-108-105-080	C-RES,U 1M-1/16W J	a
MAIN	O R	0501	88-108-123-080	C-RES,U 12K-1/16W J	a
MAIN	O R	0502	88-108-123-080	C-RES,U 12K-1/16W J	a
MAIN	O R	0503	88-108-123-080	C-RES,U 12K-1/16W J	a
MAIN	O R	0504	88-108-123-080	C-RES,U 12K-1/16W J	a
MAIN	X R	0505	88-108-183-080	C-RES,U 18K-1/16W J	a
MAIN	X R	0506	88-108-183-080	C-RES,U 18K-1/16W J	a
MAIN	X R	0507	88-108-183-080	C-RES,U 18K-1/16W J	a
MAIN	X R	0508	88-108-183-080	C-RES,U 18K-1/16W J	a
MAIN	X R	0509	88-121-103-080	RES,10K-1/8W J	a
MAIN	O R	0510	87-010-805-080	C-CAP,S 1-16 Z F GRM	a
MAIN	X R	0521	88-108-100-080	C-RES,U 10-1/16W J	a
MAIN	X R	0713	88-108-472-080	C-RES,U 4.7K-1/16W J	a
MAIN	X R	0714	88-108-472-080	C-RES,U 4.7K-1/16W J	a
MAIN	O R	0715	88-108-562-080	C-RES,U 5.6K-1/16W J	a
MAIN	O R	0716	88-108-562-080	C-RES,U 5.6K-1/16W J	a
MAIN	O R	0717	88-108-102-080	C-RES,U 1K-1/16W J	a
MAIN	O R	0719	88-108-102-080	C-RES,U 1K-1/16W J	a
MAIN	O R	0721	88-108-102-080	C-RES,U 1K-1/16W J	a
MAIN	O R	0722	88-108-102-080	C-RES,U 1K-1/16W J	a
					CDC-R227 YZSF
MAIN	O R	0723	88-108-102-080	C-RES,U 1K-1/16W J	a
MAIN	O R	0724	88-108-102-080	C-RES,U 1K-1/16W J	a
MAIN	O R	0725	88-108-102-080	C-RES,U 1K-1/16W J	a
MAIN	O R	0726	88-108-102-080	C-RES,U 1K-1/16W J	a
MAIN	O R	0727	88-108-562-080	C-RES,U 5.6K-1/16W J	a
MAIN	O R	0728	88-108-562-080	C-RES,U 5.6K-1/16W J	a
MAIN	X R	0729	88-108-472-080	C-RES,U 4.7K-1/16W J	a
MAIN	X R	0730	88-128-472-080	C-RES, 4.7K-1/8W J	a
MAIN	O R	0731	88-108-223-080	C-RES,U 22K-1/16W J	a
MAIN	O R	0801	88-108-103-080	C-RES,U 10K-1/16W J	a
MAIN	X R	0802	88-148-681-080	C-RES, 680-1/2W J	a
MAIN	X R	0804	88-148-229-080	C-RES, 2.2-1/2W J	a
MAIN	X R	0808	88-108-273-080	C-RES,U 27K-1/16W J	a
MAIN	O R	0809	88-108-103-080	C-RES,U 10K-1/16W J	a
MAIN	O R	0810	88-108-102-080	C-RES,U 1K-1/16W J	a
MAIN	X R	0811	88-108-681-080	C-RES,U 680-1/16W J	a
MAIN	X R	0814	88-118-680-080	C-RES,S 68-1/10W J	a
MAIN	X R	0815	88-108-472-080	C-RES,U 4.7K-1/16W J	a
MAIN	X R	0904	88-121-563-080	RES,56K-1/8W J	a
MAIN	O R	0905	88-108-153-080	C-RES,U 15K-1/16W J	a
					CDC-R227 YZSF
MAIN	O R	0908	88-108-473-080	C-RES,U 47K-1/16W J	a
MAIN	O R	0911	88-108-473-080	C-RES,U 47K-1/16W J	a
MAIN	O R	0912	88-108-223-080	C-RES,U 22K-1/16W J	a
MAIN	X R	0914	88-129-000-080	C-JUMPER, 3216	a
MAIN	X R	0915	88-128-104-080	C-RES, 100K-1/8W J	a
MAIN	X R	0916	88-108-104-080	C-RES,U 100K-1/16W J	a
MAIN	X R	0918	88-128-473-080	C-RES, 47K-1/8W J	a
MAIN	O R	0919	88-108-473-080	C-RES,U 47K-1/16W J	a
MAIN	X R	0920	88-128-473-080	C-RES, 47K-1/8W J	a
MAIN	X R	0921	88-121-222-080	RES,2.2K-1/8W J	a
MAIN	X R	0922	88-121-222-080	RES,2.2K-1/8W J	a
MAIN	X R	0923	88-121-222-080	RES,2.2K-1/8W J	a
MAIN	X R	0924	88-121-222-080	RES,2.2K-1/8W J	a
MAIN	X R	0925	88-108-222-080	C-RES,U 2.2K-1/16W J	a
MAIN	X R	0926	88-108-222-080	C-RES,U 2.2K-1/16W J	a
MAIN	X R	0927	88-108-222-080	C-RES,U 2.2K-1/16W J	a
MAIN	X R	0928	88-108-104-080	C-RES,U 100K-1/16W J	a
MAIN	X R	0929	88-108-104-080	C-RES,U 100K-1/16W J	a
MAIN	X R	0930	88-108-222-080	C-RES,U 2.2K-1/16W J	a
MAIN	X R	0931	88-108-222-080	C-RES,U 2.2K-1/16W J	a
					CDC-R227 YZSF
MAIN	X R	0932	88-108-222-080	C-RES,U 2.2K-1/16W J	a
MAIN	X R	0933	88-108-222-080	C-RES,U 2.2K-1/16W J	a
MAIN	X R	0935	88-108-104-080	C-RES,U 100K-1/16W J	a
MAIN	X R	0936	88-108-104-080	C-RES,U 100K-1/16W J	a
MAIN	X R	0937	88-121-104-080	RES,100K-1/8W J	a
MAIN	O R	0938	88-108-473-080	C-RES,U 47K-1/16W J	a
MAIN	X R	0939	88-108-104-080	C-RES,U 100K-1/16W J	a
MAIN	O R	0940	88-108-224-080	C-RES,U 220K-1/16W J	a
MAIN	O R	0942	88-108-102-080	C-RES,U 1K-1/16W J	a
MAIN	O R	0944	88-108-272-080	C-RES,U 2.7K-1/16W J	a
MAIN	X R	0945	88-108-104-080	C-RES,U 100K-1/16W J	a
MAIN	X R	0946	88-108-104-080	C-RES,U 100K-1/16W J	a
MAIN	X R	0947	88-108-222-080	C-RES,U 2.2K-1/16W J	a
MAIN	X R	0948	88-121-104-080	RES,100K-1/8W J	a
MAIN	X R	0949	88-108-104-080	C-RES,U 100K-1/16W J	a
MAIN	X R	0950	88-108-104-080	C-RES,U 100K-1/16W J	a
MAIN	X R	0951	88-108-104-080	C-RES,U 100K-1/16W J	a
MAIN	O R	0952	88-108-473-080	C-RES,U 47K-1/16W J	a
MAIN	O R	0955	88-108-473-080	C-RES,U 47K-1/16W J	a
MAIN	O	SFR0101	87-024-437-080	SFR,100K H RH063MC	a

# ELECTRICAL PARTS LIST -8/10

! =  $\Delta$  SAFTY PARTS  
 C = Components marked

All components used on this model at the production line are shown in this service manual.  
 However, please note that not all components will be available as spare parts for after-sales service.  
 Components marked S and O are designated as spare parts for service and will be stocked at the spare parts centers.  
 Components marked X and R are not designated as spare parts for after sales service, and will not be stocked at the spare parts centers.

UNIT-NAME	! C	REF-NO	PARTS-NO	PARTS-NAME	SUFFIX&MODEL
					CDC-R227
					YZSF
MAIN	O	SW 0901	87-A91-070-010	SW,TACT SKHHLV	a
MAIN	O	TU 0101	8C-KTA-621-010	TU UNIT, FAE347-E30	a
MAIN	X	W 0801	8A-KCG-615-010	WIRE,400 P-MUTE	a
MAIN	O	X 0151	87-A70-091-010	VIB,XTAL 4.332MHZ CSA-309	a
MAIN	O	X 0901	87-A70-372-080	VIB,XTAL 6.3MHZ HC-49/U-S	a

# ELECTRICAL PARTS LIST -9/10 (BZG-3 CNF) -1/1

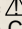
- ! =  SAFETY PARTS
- C = Components marked

All components used on this model at the production line are shown in this service manual.  
 However, please note that not all components will be available as spare parts for after-sales service.  
 Components marked S and O are designated as spare parts for service and will be stocked at the spare parts centers.  
 Components marked X and R are not designated as spare parts for after sales service, and will not be stocked at the spare parts centers.

UNIT-NAME	! C	REF-NO	PARTS-NO	PARTS-NAME	SUFFIX&MODEL
					BZG-3 CNF
SW	O	SW 1	87-A92-279-080	C-SW, PUSH 2-1	ESE22MH22XQ
SW	O	SW 2	87-A92-279-080	C-SW, PUSH 2-1	ESE22MH22XQ

○チップ抵抗部品コード／CHIP RESISTOR PART CODE

チップ抵抗部品コードの成り立ち

Chip Resistor Part Coding



A  
抵抗部品コード  
Resistor Code

桁表示  
Figure  
抵抗値  
Value of resistor

チップ抵抗  
Chip resistor

容量 Wattage	種類 Type	許容誤差 Tolerance	記号 Symbol	寸法/Dimensions (mm)			抵抗コード : A Resistor Code : A	
				外形/Form	L	W		t
1/16W	1005	± 5%	CJ		1.0	0.5	0.35	104
1/16W	1608	± 5%	CJ		1.6	0.8	0.45	108
1/10W	2125	± 5%	CJ		2	1.25	0.45	118
1/8W	3216	± 5%	CJ		3.2	1.6	0.55	128

TRANSISTOR ILLUSTRATION -1/1

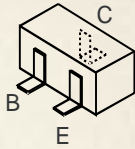

2SA1037AK(Q) □  
2SC2412KR □  
DTA114TKA □  
DTA124EKA



2SD2012 □  
2SB1375



2SB1326 □  
2SD1858 TV





32 31 30 29 28 27 26 25 24 23 22 21 20 19 18 17 16 15 14 13 12 11 10 9 8 7 6 5 4 3 2 1

A  
B  
C  
D  
E  
F  
G  
H  
I  
J  
K  
L  
M  
N  
O  
P  
Q  
R  
S  
T  
U

MAIN C.B

TO FRONT C.B CON601

SW901  
RESET

TO CD C.B CON201

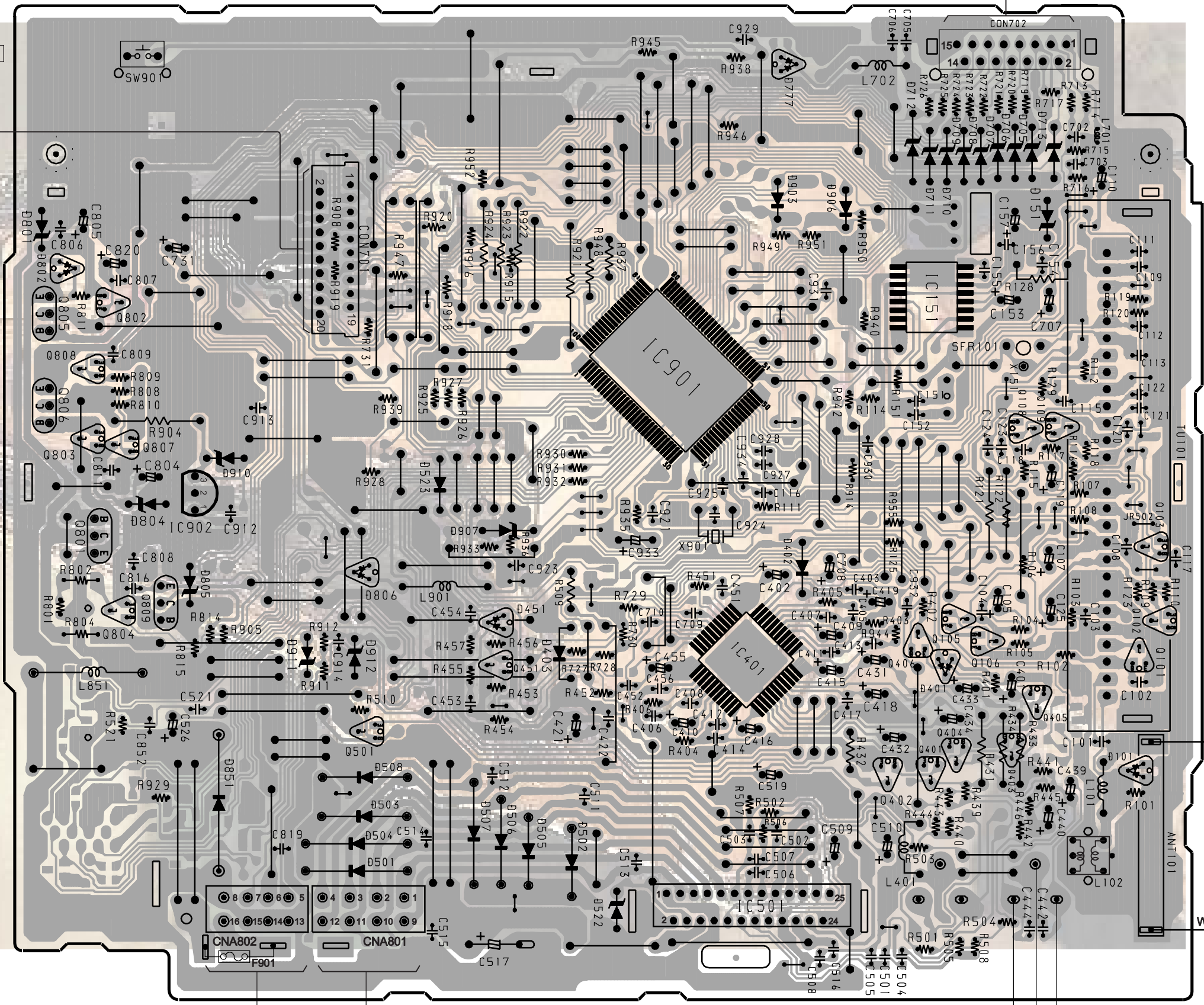

TO POWER SUPPLY / SPEAKER CONNECTOR

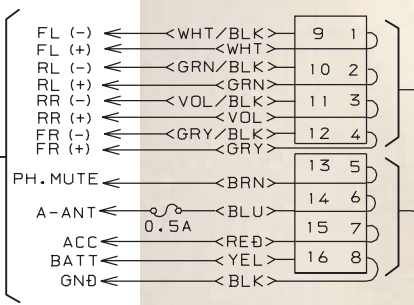





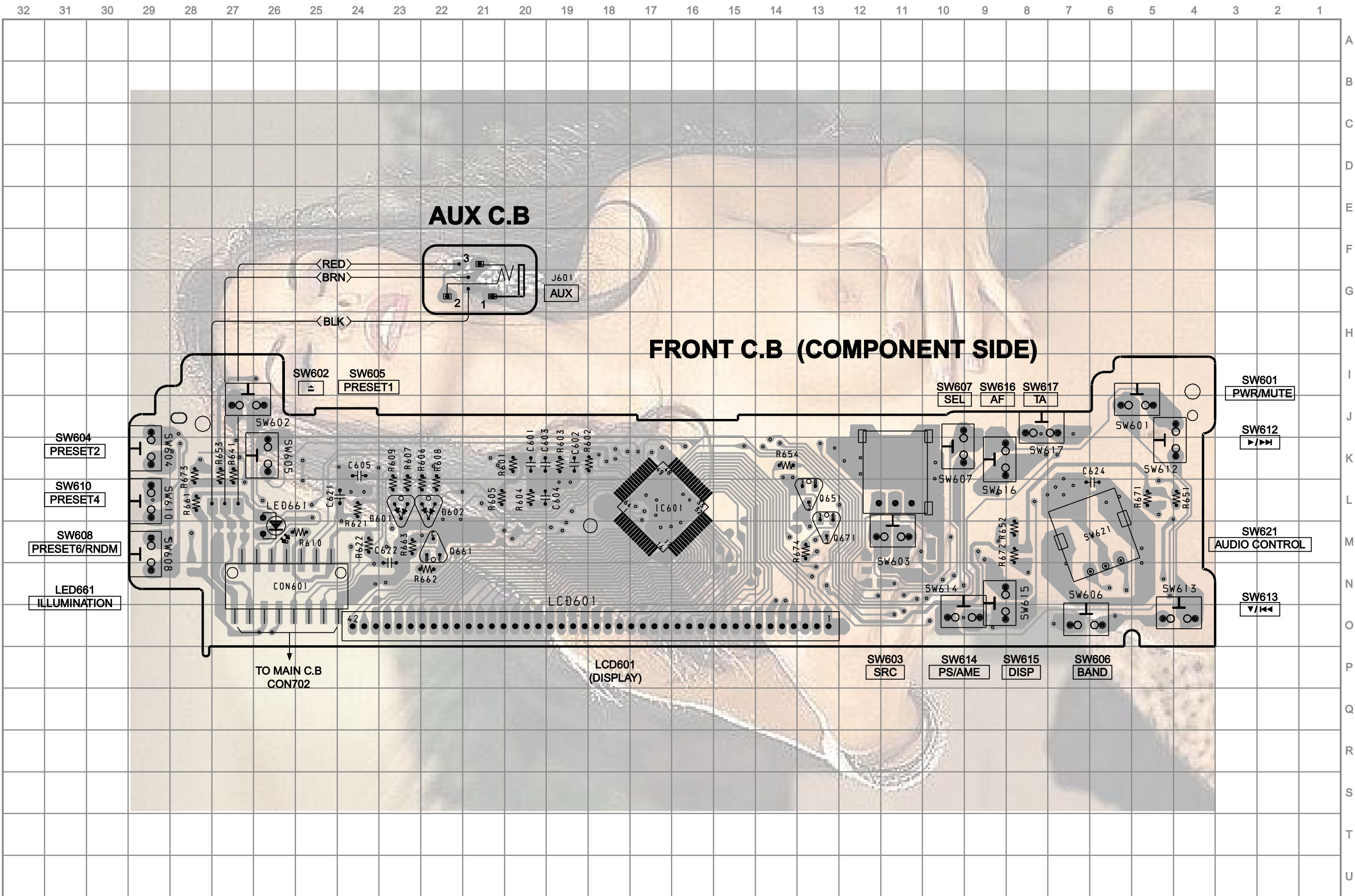

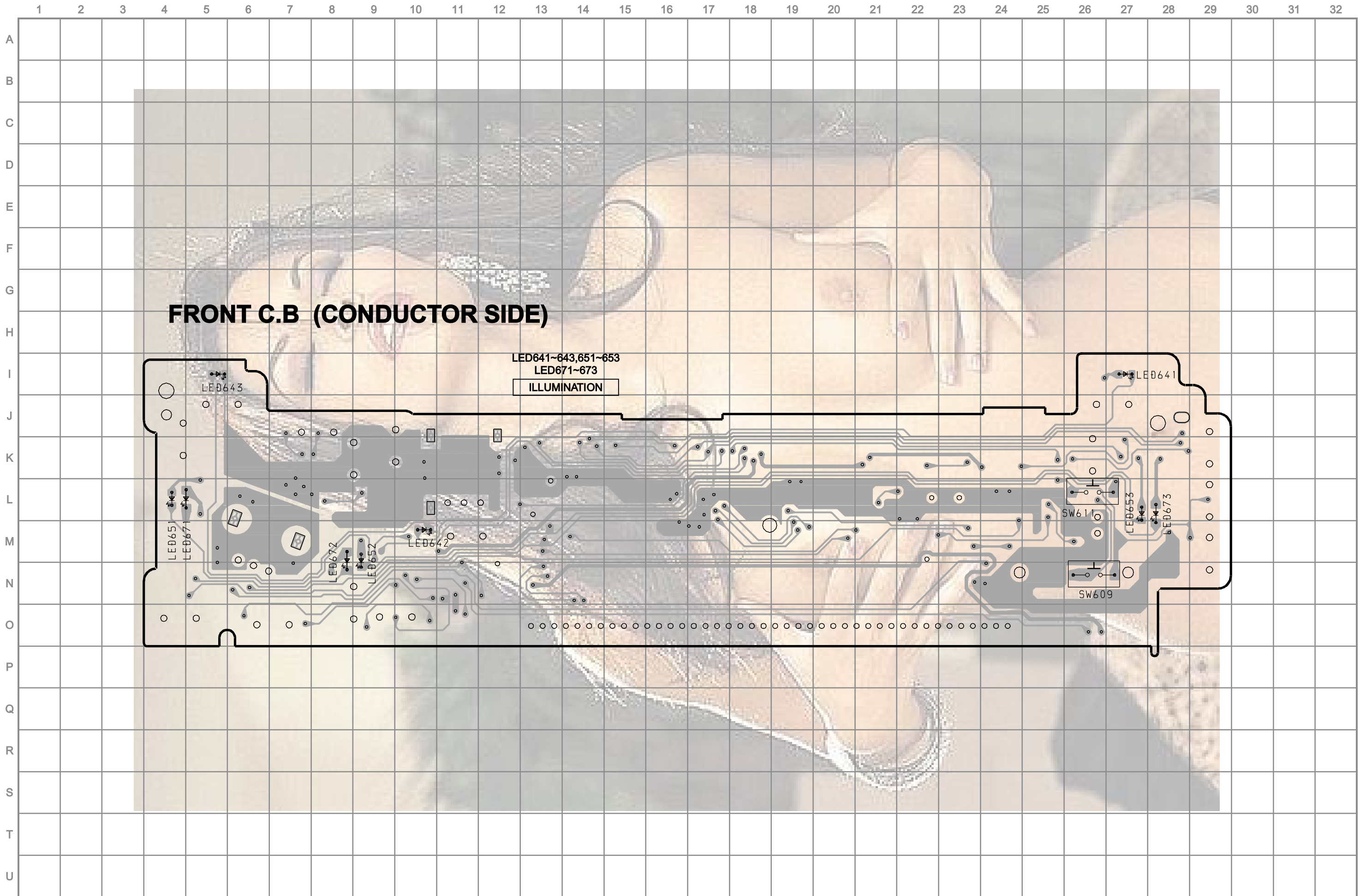



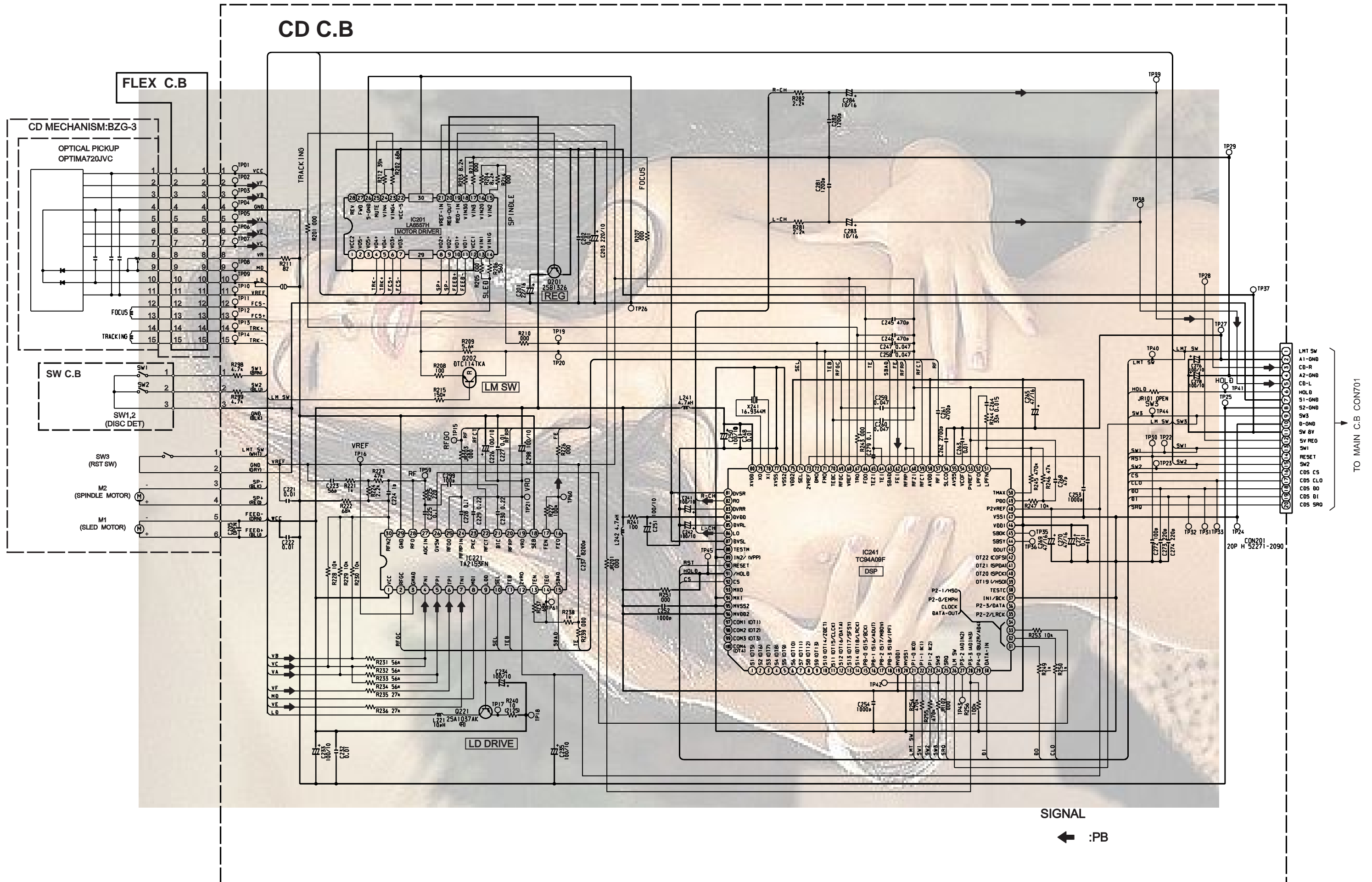

32 31 30 29 28 27 26 25 24 23 22 21 20 19 18 17 16 15 14 13 12 11 10 9 8 7 6 5 4 3 2 1

A  
B  
C  
D  
E  
F  
G  
H  
I  
J  
K  
L  
M  
N  
O  
P  
Q  
R  
S  
T  
U

# CD C.B (COMPONENT SIDE)

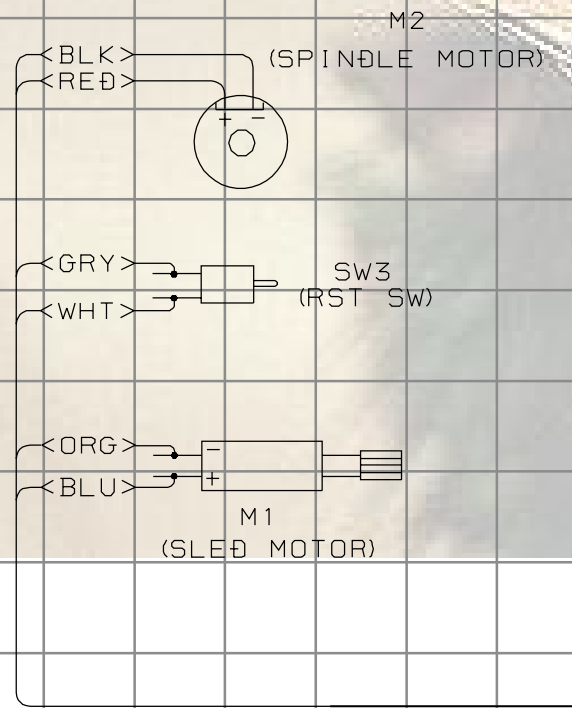
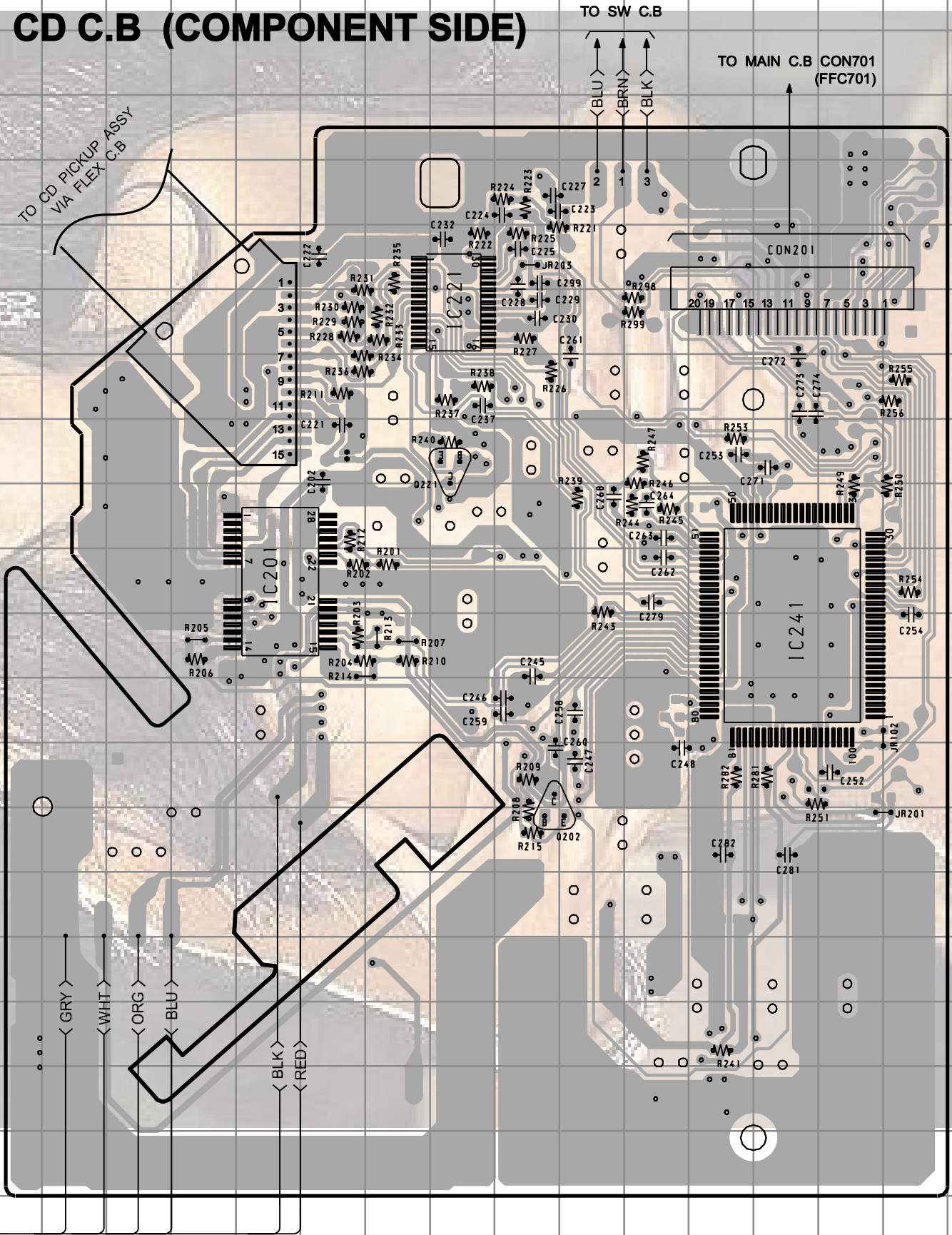

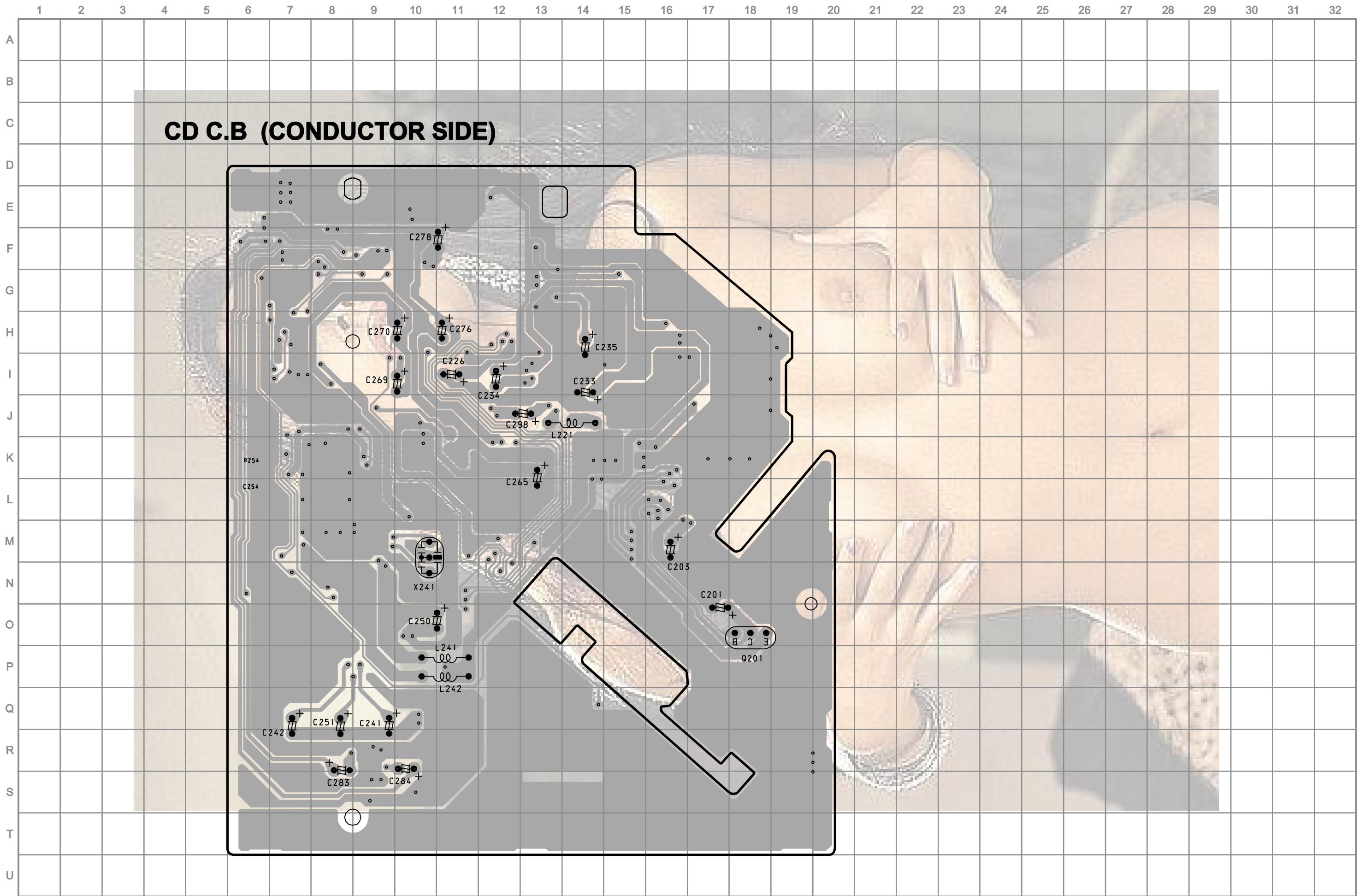

WIRING -4/4 (FLEX/SW) -1/1

16 | 15 | 14 | 13 | 12 | 11 | 10 | 9 | 8 | 7 | 6 | 5 | 4 | 3 | 2 | 1

A  
B  
C  
D  
E  
F  
G  
H  
I  
J  
K  
L  
M  
N  
O  
P  
Q  
R  
S  
T  
U

FLEX C.B  
(2/2)

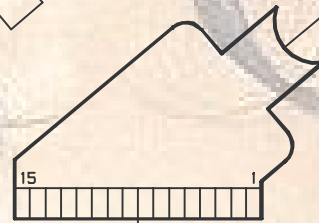
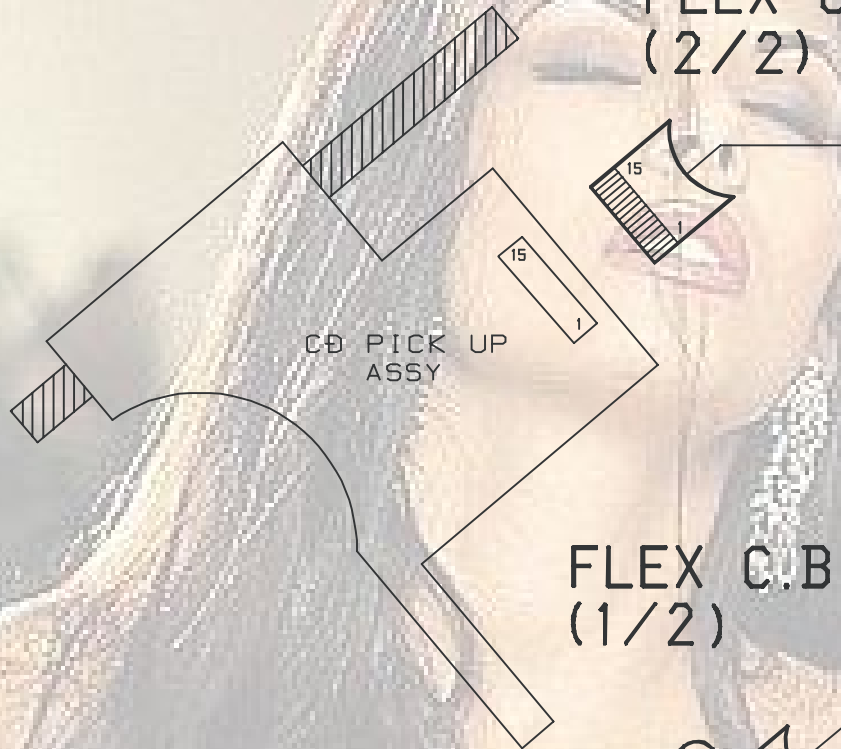

TO CD C.B

TO CD C.B

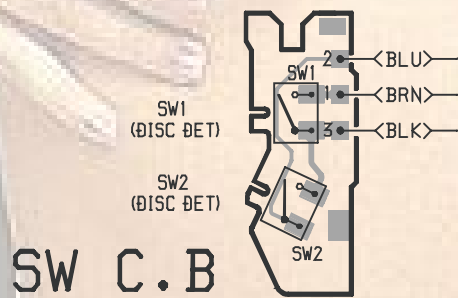



# VOLTAGE CHART -1/4

## IC401 LC75374E

NO.	PIN NAME	TUNER(FM)	CD	AUX
1	RVR IN	4.4	4.4	4.4
2	R COM	4.4	4.4	4.4
3	RT1	4.4	4.4	4.4
4	RT2	4.4	4.4	4.4
5	RT3	4.4	4.4	4.4
6	RT OUT	4.4	4.4	4.4
7	RS IN	4.4	4.4	4.4
8	NC	0	0	0
9	NC	0	0	0
10	RS3	4.4	4.4	4.4
11	RS	4.4	4.4	4.4
12	FR IN	4.4	4.4	4.4
13	FR OUT	4.4	4.4	4.4
14	RR OUT	4.4	4.4	4.4
15	VSS	0	0	0
16	CL	0	0	0
17	DI	0	0	0
18	CE	0	0	0
19	VREF	4.4	4.4	4.4
20	RL OUT	4.4	4.4	4.4
21	FL OUT	4.4	4.4	4.4
22	FL IN	4.4	4.4	4.4
23	LS OUT	4.4	4.4	4.4
24	LS3	4.4	4.4	4.4
25	NC	0	0	0
26	NC	0	0	0
27	LS IN	4.4	4.4	4.4
28	LT OUT	4.4	4.4	4.4
29	LT3	4.4	4.4	4.4
30	LT2	4.4	4.4	4.4
31	LT1	4.4	4.4	4.4
32	L COM	4.4	4.4	4.4
33	LVR IN	4.4	4.4	4.4
34	LSELO	4.4	4.4	4.4
35	AUX (L)	4.4	4.4	4.4
36	CD (L)	4.4	4.4	4.4
37	RA (L)	4.4	4.4	4.4
38	TA (L)	4.4	4.4	4.4
39	VDD	8.5	8.5	8.5
40	TA (R)	4.4	4.4	4.4
41	RA (R)	4.4	4.4	4.4
42	CD (R)	4.4	4.4	4.4
43	AUX (R)	4.4	4.4	4.4
44	RSELO	4.4	4.4	4.4



# VOLTAGE CHART -2/4

## IC151 SAA6579T

NO.	PIN NAME	TUNER(FM)	CD	AUX
1	DUAL	DATA	DATA	DATA
2	DATA	DATA	DATA	DATA
3	VREF	2.5	2.5	2.5
4	MUX	2.5	2.5	2.5
5	VDD	5.0	5.0	5.0
6	GND	0	0	0
7	CIN	2.5	2.5	2.5
8	SCOUT	2.5	2.5	2.5
9	MODE	0	0	0
10	TEST	0	0	0
11	GND	0	0	0
12	VDD	5.0	5.0	5.0
13	XIN	2.2	2.2	2.2
14	XOUT	2.6	2.6	2.6
15	T57	2.5	2.5	2.5
16	CL	2.5	2.5	2.5

## TU101 FAE347-E30

NO.	PIN NAME	TUNER(FM)	TUNER(AM)	CD	AUX
1	AM ANT	0	0	0	0
2	FM ANT	0	0	0	0
3	AM DX/LOC	0	0	0	0
4	FMDX/LOC	7.5	0.5	0	0
5	GND	0	0	0	0
6	FM VT	1.3	4.9	1.2~7.0	1.2~7.0
7	GND	0	0	0	0
8	GND	0	0	0	0
9	AM +B	0.8	8.5	0.8	0.8
10	GND	0	0	0	0
11	AM/FM OSC	0.2	0.2	0.2	0.2
12	FM +B	7.9	0.2	7.9	7.9
13	TU +B	8.4	8.3	8.3	8.3
14	AM VT	1.4	1.9	1.8	1.7
15	GND	0	0	0	0
16	LCH	3.3	3.3	3.3	3.3
17	RCH	3.3	3.3	3.3	3.3
18	GND	0	0	0	0
19	NC	0	0	0	0
20	IF	0	0	0	4.7
21	S-METER	0.3	1.8	0~3.0	0~3.0
22	SD/ST	4.9	4.8	0	0
23	SNC	0	0	0	0
24	DET OUT	4.0	1.2	4.0	4.0
25	TU +B	8.4	8.3	8.3	8.3
26	MUTE	2.5	0	2.5	2.5

# VOLTAGE CHART -3/4

## IC901 (1/2) LC75854W

NO.	PIN NAME	TUNER(FM)	CD	AUX
1	P1/ S1	4.0	4.0	4.0
2	P2/ S2	4.0	4.0	4.0
3	P3/ S3	4.0	4.0	4.0
4	P4/ S4	2.1	2.1	2.1
5	S5	2.1	2.1	2.1
6	S6	2.1	2.1	2.1
7	S7	2.1	2.1	2.1
8	S8	2.1	2.1	2.1
9	S9	2.1	2.1	2.1
10	S10	2.1	2.1	2.1
11	S11	2.1	2.1	2.1
12	S12	2.1	2.1	2.1
13	S13	2.1	2.1	2.1
14	S14	2.1	2.1	2.1
15	S15	2.1	2.1	2.1
16	S16	2.1	2.1	2.1
17	S17	2.1	2.1	2.1
18	S18	2.1	2.1	2.1
19	S19	2.1	2.1	2.1
20	S20	2.1	2.1	2.1
21	S21	2.1	2.1	2.1
22	S22	2.1	2.1	2.1
23	S23	2.1	2.1	2.1
24	S24	2.1	2.1	2.1
25	S25	2.1	2.1	2.1
26	S26	2.1	2.1	2.1
27	S27	2.1	2.1	2.1
28	S28	2.1	2.1	2.1
29	S29	2.1	2.1	2.1
30	S30	2.1	2.1	2.1
31	S31	2.1	2.1	2.1
32	S32	2.1	2.1	2.1
33	S33	2.1	2.1	2.1
34	S34	2.1	2.1	2.1
35	S35	2.1	2.1	2.1
36	S36	2.1	2.1	2.1
37	S37	2.1	2.1	2.1
38	S38	2.1	2.1	2.1
39	S39	2.1	2.1	2.1
40	COM1	2.1	2.1	2.1
41	COM2	2.1	2.1	2.1
42	COM3	2.1	2.1	2.1
43	COM4	2.1	2.1	2.1
44	KS1	2.1	2.1	2.1

## VOLTAGE CHART -4/4

### IC901 (2/2) LC75854W

NO.	PIN NAME	TUNER(FM)	CD	AUX
45	KS2	2.1	2.1	2.1
46	KS3	4.1	4.1	4.1
47	KS4	4.1	4.1	4.1
48	KS5	4.1	4.1	4.1
49	KS6	4.1	4.1	4.1
50	KI1	0	0	0
51	KI2	0	0	0
52	KI3	0	0	0
53	KI4	0	0	0
54	KI5	0	0	0
55	TEST	0	0	0
56	VDD	4.1	4.1	4.1
57	VDD1	2.7	2.7	2.7
58	VDD2	1.4	1.4	1.4
59	VSS	0	0	0
60	OSC	3.2	3.2	3.2
61	DO	4.1	4.1	4.1
62	CE	0	0	0
63	CL	4.6	4.6	4.6
64	DI	0	0	0

### IC501 LA4743J

NO.	PIN NAME	TUNER(FM)	CD	AUX
1	TAB	0	0	0
2	PWR GND2	0	0	0
3	OUT2(-)	2.8	2.8	2.8
4	ST BY	4.2	4.2	4.2
5	OUT2(+)	2.8	2.8	2.8
6	VCC1/2	1.4	1.4	1.4
7	OUT1(-)	2.8	2.8	2.8
8	PWR GND1	0	0	0
9	OUT1(+)	2.8	2.8	2.8
10	RF	1.4	1.4	1.4
11	IN1	3.0	3.0	3.0
12	IN2	3.1	3.1	3.1
13	PRE - GND	0	0	0
14	IN4	3.0	3.0	3.0
15	IN3	3.0	3.0	3.0
16	ON TIME C	2.5	2.5	2.5
17	OUT3(+)	2.8	2.8	2.8
18	PWR GND3	0	0	0
19	OUT3(-)	2.8	2.8	2.8
20	VCC3/4	1.4	1.4	1.4
21	OUT4(+)	2.8	2.8	2.8
22	MUTE	4.2	4.2	4.2
23	OUT4(-)	2.8	2.8	2.8
24	PWR GND4	0	0	0
25	NC	0	0	0

<SEGMENT>

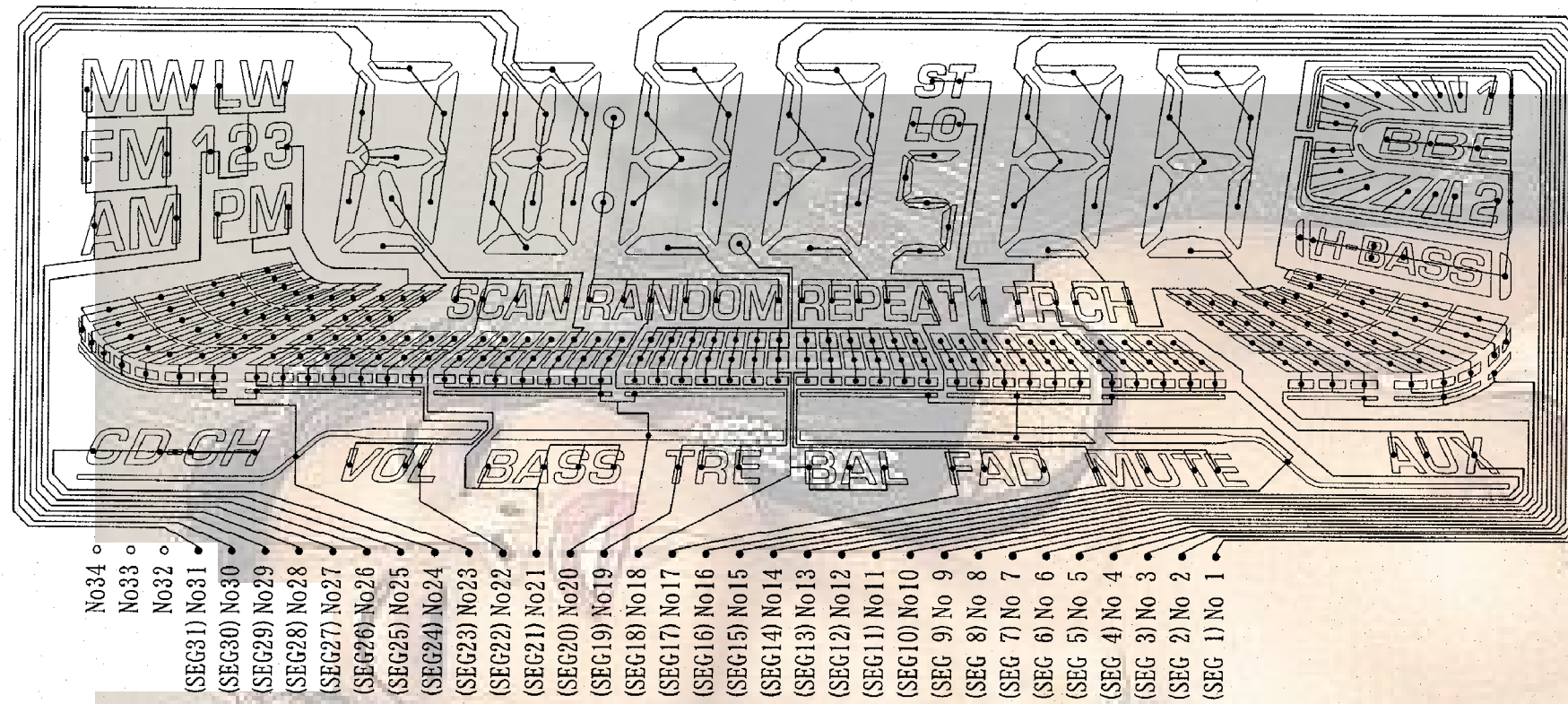

<COMMON>

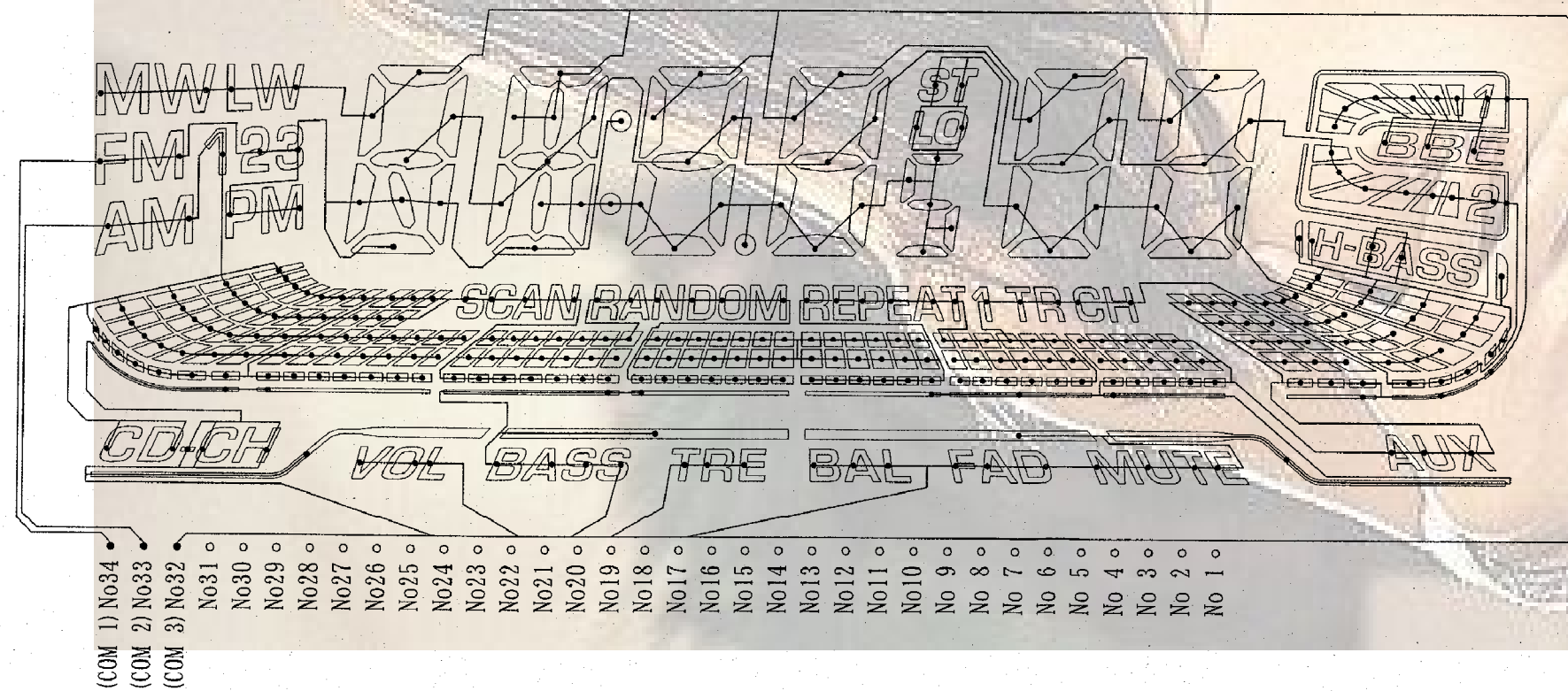



<WIRING TABLE>

No	1	2	3	4	5	6	7	8	9	10	11	12	13	14	15	16	17
COM1	4e	4c	3e	3c	2e	2c	1e	1c	A	H-BASS	1d	2d	ST	LO	35	3d	DOT
COM2	4g	4b	3g	3b	2g	2b	1g	1b	BBE2	2	B	CH	TR	R1	E	REPEAT	F
COM3	4f	4a	3f	3a	2f	2a	1f	1a	BBE1	1,BBE	3,4,5	C	AUX	D	6,7,8, 13,14	MUTE	FAD

No	18	19	20	21	22	23	24	25	26	27	28	29	30	31	32	33	34
COM1	4d	COLON	6j	6d	B3	PM	—	B2	FM	6e	6c	5d	5i	5c	—	—	COM1
COM2	G	RANDOM	H	SCAN	I	J	CD	B1	AM	6g	6b	5e	5g	5b	—	COM2	—
COM3	BAL	TRE	9,10,15	BASS	VOL	11,12,16	-CH	LW	MW	6f	6a	5f	5h	5a	COM3	—	—

<CHARACTER>



IC BLOCK DIAGRAM -1/4

IC151, SAA6579T

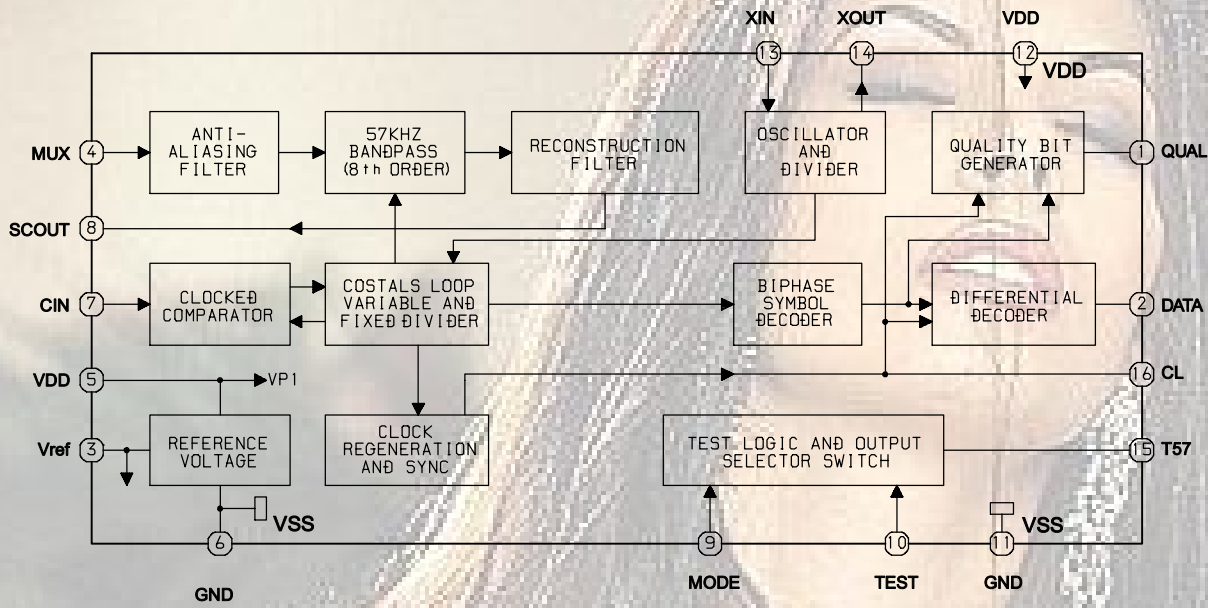

IC401, LC75374E

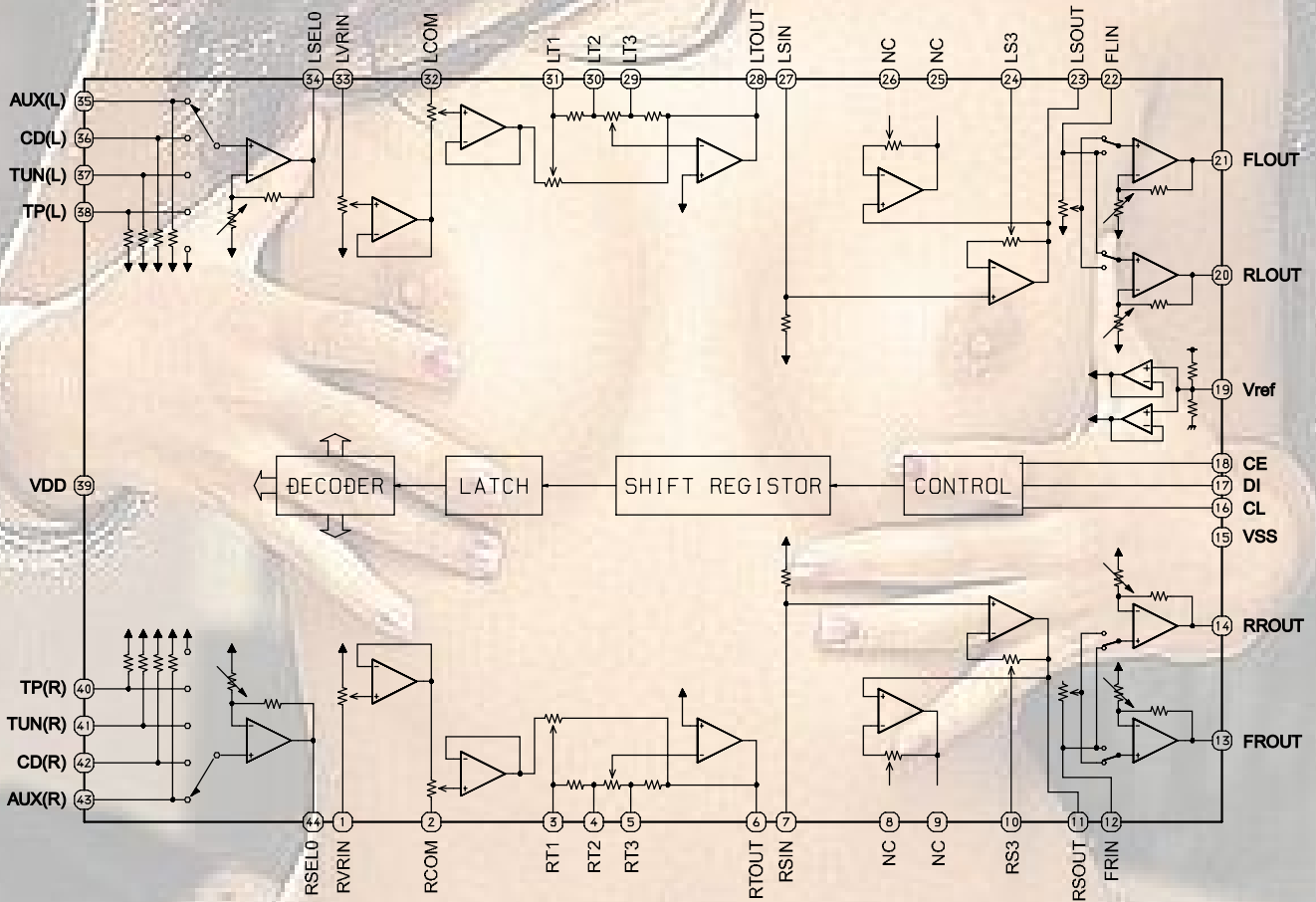

IC BLOCK DIAGRAM -2/4

IC501,LA4743J

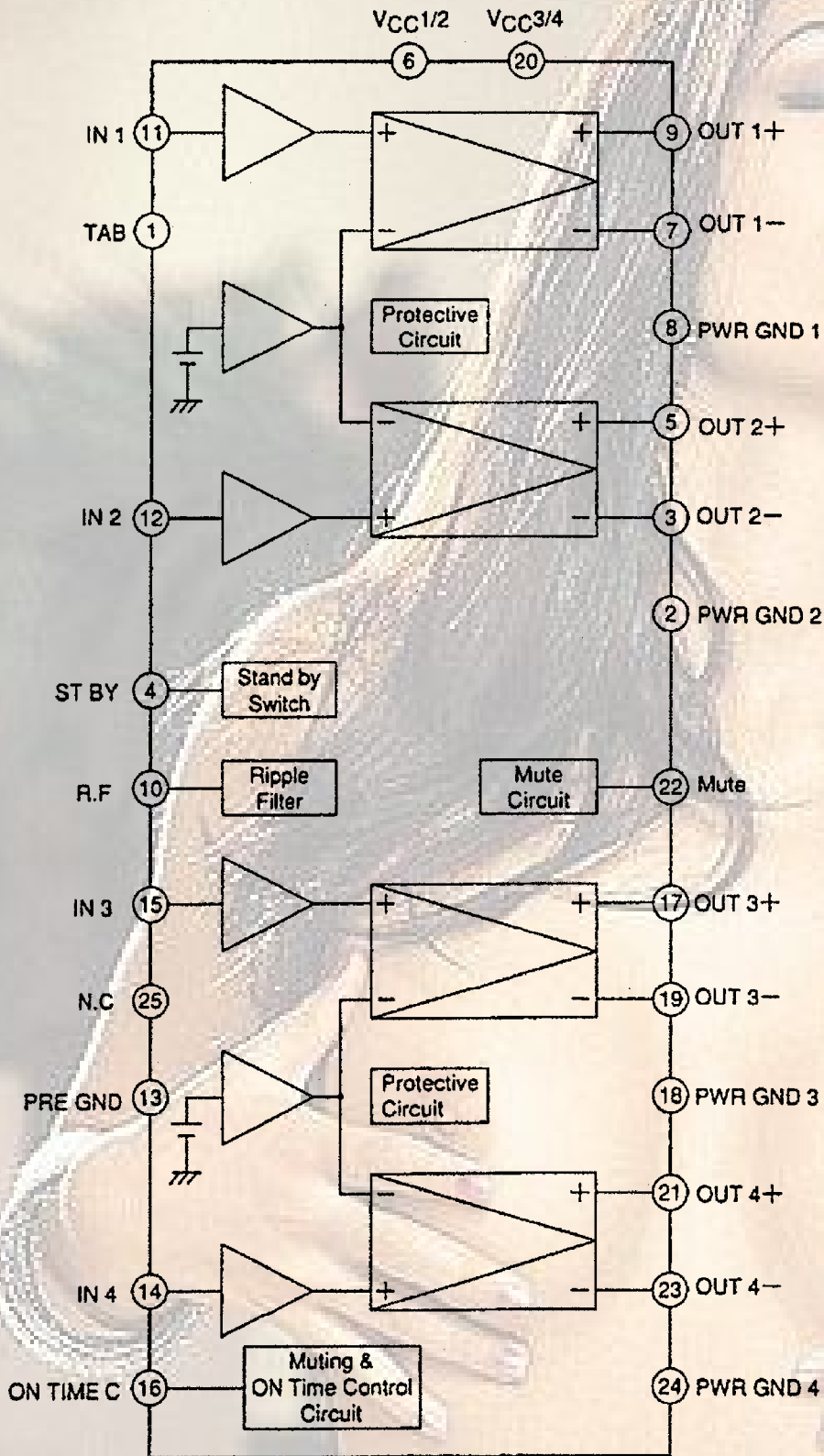



IC BLOCK DIAGRAM -3/4

IC221,TA2153FN

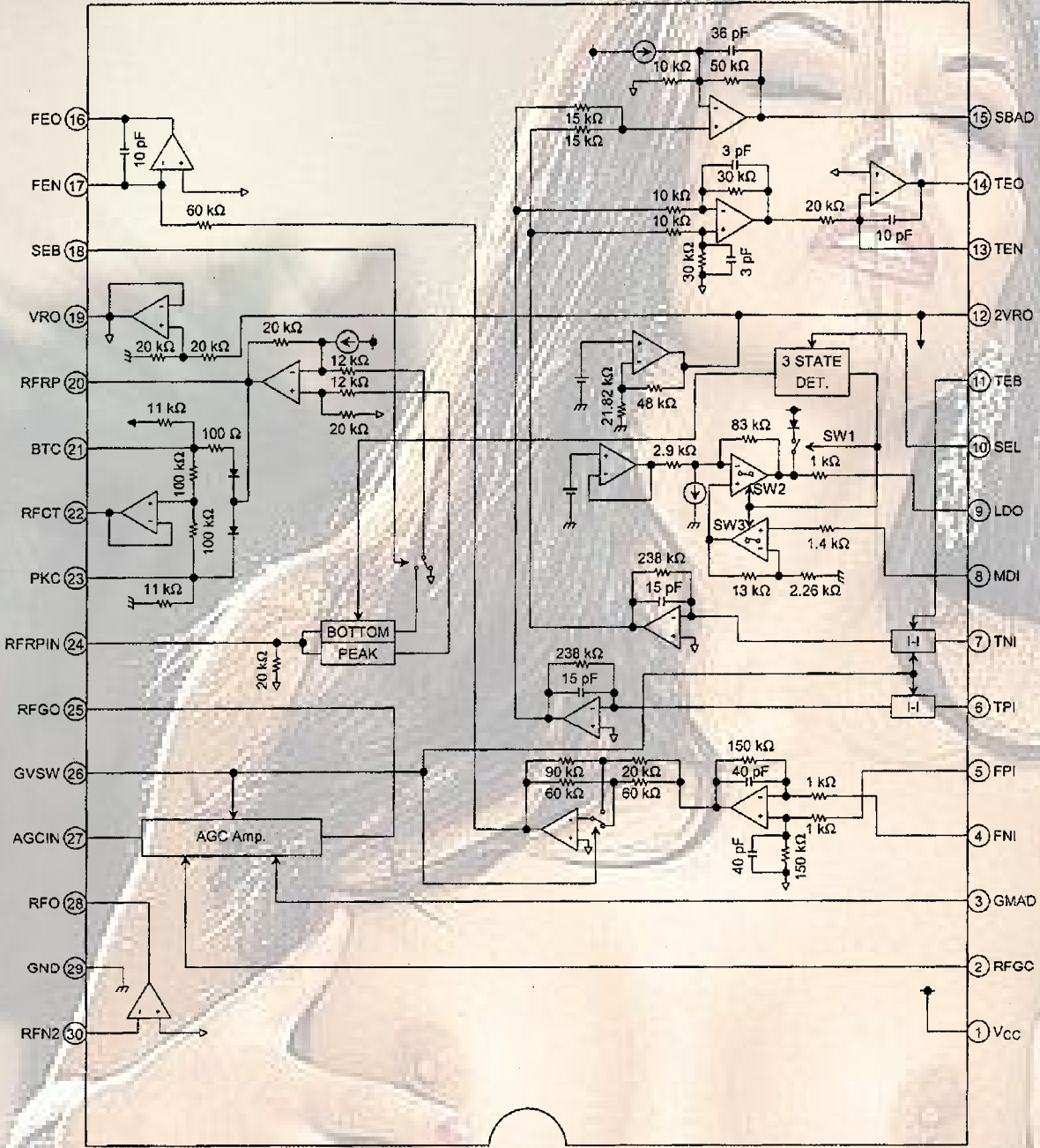

IC BLOCK DIAGRAM -4/4

IC601,LC75854W

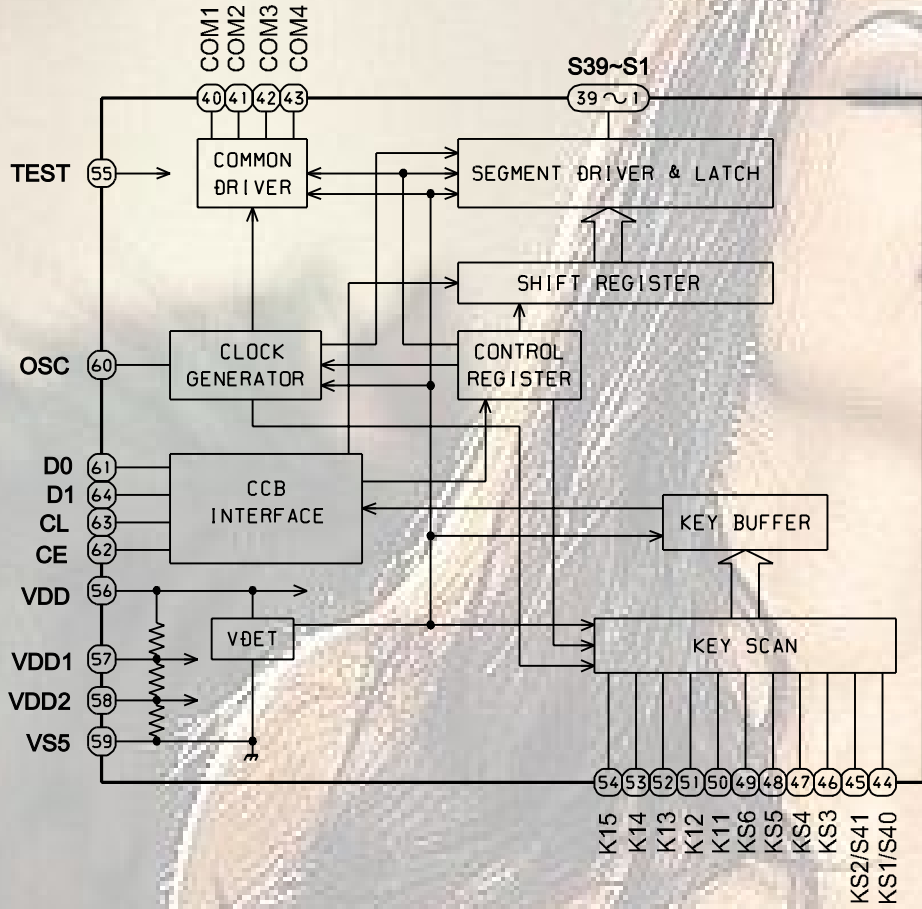

IC201,LA6557H

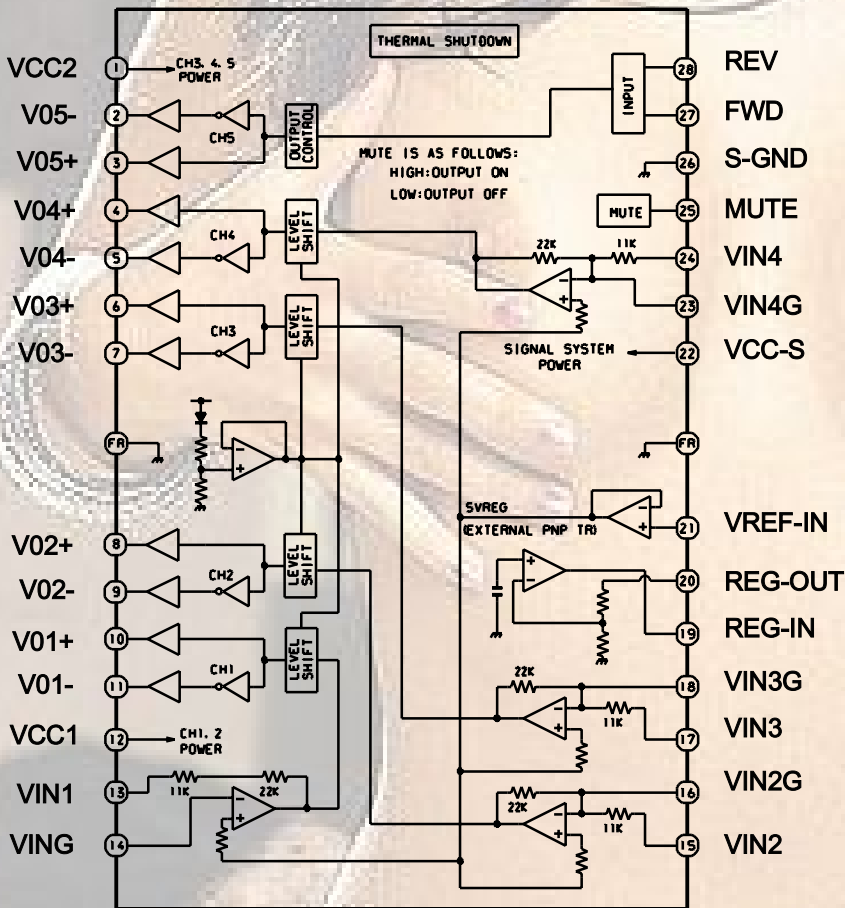

# IC DESCRIPTION -1/2 (UPD178078GF-566-3BA) -1/3

Pin No.	Pin Name	I/O	Description
1	BATT IN	I	BATT ON/OFF input
2	DFP IN	I	Detects whether DFP (front panel) is provided or not.
3	LCD DI	I/O	LCD DRV data input
4	LCD DO	O	Open when not used. LCD DRV data output.
5	LCD CLO	O	LCD DRV clock output.
6	LCD CE	O	LCD DRV CE output.
7	BBE 1	-	BBE select output. Open when not used.
8	CDS DI	I	Data input from CDS.
9	CDS DO	O	Data output to CDS.
10	CDS CLO	O	Clock input from CDS.
11	CD DI	I	Data input from CD changer. Pulled down when not used.
12	CD DO	O	Data output to CD changer. Open when not used.
13	CD CLI	I	Clock input from CD changer. Open when not used.
14	CD DISP SEL	O	Determines the timing with which data is transferred to the head unit. Open when not used.
15	CD CONNECT	I	CD changer connection check. Pulled down when not used.
16	BBE 2	-	BBE select output. Open when not used.
17	CD CLO	O	Clock output to CD changer. Open when not used.
18	E-VOL CLO	O	Clock output to electronic VR
19	E-VOL DO	O	Data putput to electronic VR
20	E-VOL CE	O	CE output to electronic VR
21	LOC/DX	O	LOC/DX switching output during radio seek (LOC: "H", DX: "L"). Open when not used.
22	DSSA	O	Outputs "H" only when DSSA L/R are operating.
23	NC	-	NOT USE
24	PHONE MUTE	I	Muting control input -20dB. Mute: "L".
25	LEVEL-M	I	Level meter signal input
26	A-VOL CONT	I	Detects microphone input for auto volume operation. Pulled down when not used.
27	VDD	-	Power supply
28	TEST	-	Only used in CD model
29	NC	-	NOT USE
30	NC	-	NOT USE
31	AM/FM S-M	I	AF signal input during RDS AF operation and FM S meter signal input
32	GND	-	Ground
33	REG CPU	-	CPU power regulator
34	VDD	-	Power supply for port
35	REG OSC	-	Regulator for oscillator circuit
36	X-OUT	-	System clock oscillator
37	X-IN	I	System clock oscillator
38	GND	-	Ground for port
39	IF REQ	O	Output to request IF count signal.
40	GND	-	Ground
41	AM IF	I	AM IF count signal input

# IC DESCRIPTION -1/2 (UPD178078GF-566-3BA) -2/3

Pin No.	Pin Name	I/O	Description
42	FM IF	I	FM IF count signal input
43	VDD	-	Power supply for PLL
44	FM OSC	I	FM local oscillation input
45	AM OSC	I	AM local oscillation input
46	GND	-	Ground for PLL
47	EO 0	O	Error output from charge pump (for FM)
48	EO 1	O	Error output from charge pump (for AM)
49	IC	-	NC
50	RESET	I	System reset input
51	RDS CLI	I	RDS clock input Pulled down when not used.
52	ACC IN	I	ACC(accessory power supply) on/off input
53	RMT IN	I	Remote control input. Pulled up when not used
54	ST IND/SD IN	I	Stop pulse input during FM/AM seek.
55	NC	-	NOT USE
56	ST-BY MUTE	O	Standby/muting output to power amp
57	POWER CONT	O	Unit power control output
58	RDS DI	I	RDS data input. Pulled down when not used.
59	BEEP	O	Beep output (3kHz, 50ms)
60	NC	-	NOT USE
61	NC	-	NOT USE
62	BAND CONT	O	AM/FM power switching output AM: "H", FM: "L"
63	CD ACC CONT	O	Transmits the power on/off status of head unit to changer. Open when not used.
64	RDS MODE	O	Outputs "H" during RDS AF operation. Open when not used.
65	POWER MUTE	O	Muting output to power amp
66	CONT 2	O	LCD DRV power control 2
67	CONT 1	O	LCD DRV power control 1
68	MUTE	O	Audio muting output
69	NC	-	NOT USE
70	NC	-	NOT USE
71	MI-1	I	Diode matrix input for initial setting
72	MI-2		
73	MI-3		
74	MO-1	O	Diode matrix output for initial setting
75	MO-2		
76	MO-3		
77	MO-4		
78	EJECT	O	DISC EJECT Singnal Input
79	S-REQ	I	CDS S-REQ SIGNAL INPUT.
80	RE1 IN	I	Rotary encoder input 1
81	RE2 IN	I	Rotary encoder input 2
82	GND	-	Ground



IC DESCRIPTION -1/2 (UPD178078GF-566-3BA) -3/3

Pin No.	Pin Name	I/O	Description
83	NC	-	NOT USE
84	PANCON1	-	NC
85	LM SW	O	LOAD/EJECT GAIN Switching Output.
86	SW1	I	Disc Detect Switch.
87	SW2	I	Disc Detect Switch. (8 cm or 12 cm)
88	SW3	O	Disc Detect Switch. (Disc IN or NOT)
89	FLAP IN	-	Pulled down
90	MF CONT	-	NC
91	SEN1	-	Pulled down
92	SEN2	-	Pulled down
93	LMT IN	I	PICK UP INSIDE Detect Switch.
94	CDS RESET	O	CDS RESET Signal output.
95	CDS SLEEP	O	CDS SLEEP Signal Output.
96	CDS CS	O	CDS CS Signal Output.
97	CDS STOP	-	Pulled down
98	RADIO CONT	O	Radio ON/OFF. Power switching output. Radio on: "H"
99	VDD PORT	-	VDD
100	GND	-	GND

## IC DESCRIPTION -2/2 (TC94A09F-301) -1/2

Pin No.	Pin Name	I/O	Description
1-14	S1-S14	-	Not connection (Open)
15-18	P8-0-P8-3	-	Not connection (Open)
19	MVDD1	-	Power supply for port
20	MVSS1	-	GND
21	P1-0	I	RST SW BZG-3 Mecha Inside SW input port.
22	P1-1	I	SW1 detect input
23	P1-2	I	SW2 detect input
24	SW3	I	SW3 detect input
25	SRQ	O	output SRQ signal
26	LM SW	O	FEED MOTER GAIN SW output
27	P3-2	-	Not connection (Open)
28	P3-3	O	M-DRIV MUTE output
29	P4-0	-	Not connection (Open)
30	DATA-IN	I	CDS DATA INPUT
31	DATA-OUT	O	CDS DATA OUTPUT
32	CLOCK	I	CDS CLOCK INPUT
33	P2-0	O	CD-DA/RW GAIN SWITCHIN OUTPUT
34-36	P2-1-P2-3	-	Not connection (Open)
37	IN1	-	GND
38	TESTC	-	Not connection (Open)
39-42	OT19-OT22	-	Not connection (Open)
43	DOUT	-	Not connection (Open)
44	SBSY	-	Not connection (Open)
45	SBOK	-	Not connection (Open)
46	VDD 1	-	VDD
47	Vss 1	-	GND
48	P2VREF	-	FOR PLL 2 VREF
49	PDO	O	EFM to PLCK difference error signal output
50	TMAX	O	TMAX DETECT output
51	LPFN	I	FOR LOW PASS filter AMP reverse input
52	LPFO	I	FOR LOW PASS filter AMP output
53	PVREF	I	FOR PLL VREF
54	VCOF	O	VCO FILTER OUTPUT
55	AVSS	-	ANALOG GND
56	SLCO	O	DATA SLICE LEVEL DAC Output
57	RFI	I	RF SIGNAL Input
58	AVDD	-	ANALOG VDD
59	RFCT	I	RFRP SIGNAL CENTER LEVEL INPUT
60	RFZI	I	RFRP ZEROCROSS INPUT
61	RFRP	I	RF RIPPLE SIGNAL INPUT
62	FEI	I	FOCUS ERROR SIGNAL INPUT

## IC DESCRIPTION -2/2 (TC94A09F-301) -2/2

Pin No.	Pin Name	I/O	Description
63	SBAD	I	SUB BEAM INCLUDE SIGNAL INPUT
64	TEI	I	TRACKING ERROR INPUT
65	TEZI	I	TRACKING ERROR ZERO CROSS INPUT
66	FOO	O	FOCUS EQUALIZER OUTPUT
67	TRO	O	TRACKING EQUALIZER OUTPUT
68	VREF	-	ANALOG Reference VDD
69	RFGC	O	RF AMPLITUDE CONTROL SIGNAL OUTPUT
70	TEBC	O	TRACKING BALANCE CONTROL SIGNAL OUTPUT
71	FMO	O	FOCUS EQUALIZER OUTPUT
72	DMO	O	DISC EQUALIZER OUTPUT
73	2VREF	-	ANALOG Reference VDD
74	SEL	O	APC CIRCUIT ON/OFF SIGNAL OUTPUT
75	VDD2	-	VDD 2
76	VSS2	-	GND 2
77	XVSS	-	For Xtal GND
78	XI	I	XTAL INPUT
79	XO	O	XTAL OUTPUT
80	XVDD	-	FOR XTAL VDD
81	DVSR	-	Rch D/A CONVERTER GND
82	RO	O	Rch DATA OUTPUT
83	DVRR	-	Rch Reference VDD
84	DVDD	-	D/A CONVERTER VDD
85	DVRL	-	Lch Reference VDD
86	LO	O	Lch DATA OUTPUT
87	DVSL	-	Lch D/A CONVERTER GND
88	TESTM	-	GND
89	VPP	-	GND
90	RESET	I	RESET SIGNAL INPUT
91	HOLD	I	Pulled UP
92	CS	I	COMMUNICATION CONTROL INPUT
93	MXO	-	Not connection (Open)
94	MXI	-	PULL DOWN
95	MVSS2	-	GND
96	MVDD2	-	VDD
97-100	COM1-COM4	-	Not connection (Open)

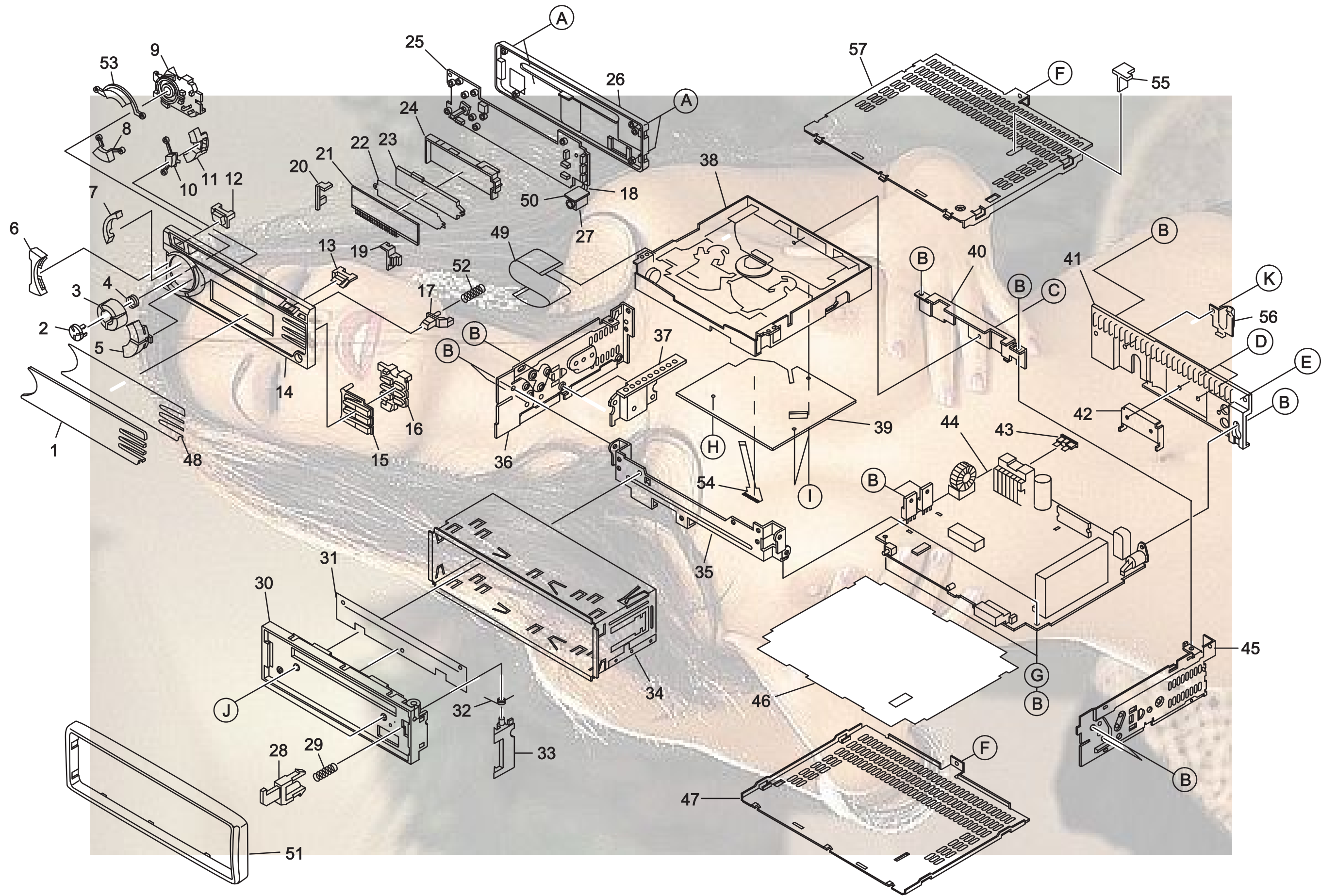



# MECHANICAL PARTS LIST -1/1

! = SAFETY PARTS  
 C = Components marked

All components used on this model at the production line are shown in this service manual.  
 However, please note that not all components will be available as spare parts for after-sales service.  
 Components marked S and O are designated as spare parts for service and will be stocked at the spare parts centers.  
 Components marked X and R are not designated as spare parts for after sales service, and will not be stocked at the spare parts centers.

UNIT-NAME	! C	REF-NO	PARTS-NO	PARTS-NAME	SUFFIX&MODEL
					CDC-R227 YZSF
		O	MC1001	8C-KCA-001-010 WINDOW, PANEL R227	a
		O	MC1002	8C-KCG-022-010 LENS, RTRY	a
		O	MC1003	8C-KCG-021-010 KNOB, RTRY	a
		O	MC1004	8B-KCG-253-010 SPR-C, ROTARY -BC2	a
		O	MC1005	8C-KC1-013-110 BTN, OV DISP/AF	a
		O	MC1006	8C-KCG-018-010 BTN, SEESAW L	a
		O	MC1007	8C-KC1-011-010 CABI, OV 2	a
		O	MC1008	8C-KCG-015-010 BTN, OV B	a
		O	MC1009	8C-KCG-215-010 LENS, L	a
		O	MC1010	8C-KCG-014-010 BTN, OV R	a
		O	MC1011	8C-KCG-013-010 BTN, OV OUT	a
		O	MC1012	8C-KCG-019-010 BTN, SQ L	a
		O	MC1013	8C-KCG-020-010 BTN, SQ R	a
		O	MC1014	8C-KCG-001-310 CABI, FRONT 16	a
		O	MC1015	8C-KCG-017-010 BTN, P. SET	a
		O	MC1016	8C-KCG-216-010 LENS, R	a
		O	MC1017	8C-KCG-023-010 BTN, DETACH	a
		O	MC1018	8A-KC7-611-010 F-CABLE, 3P (AUX)	a
		O	MC1019	8C-KCG-214-010 HLDR, LCD R	a
		O	MC1020	8C-KCG-213-010 HLDR, LCD L	a
					CDC-R227 YZSF
		O	MC1021	8C-KCA-620-010 LCD, CKC-A	a
		X	MC1022	8C-KCA-211-010 SH, LCD BLK	a
		O	MC1023	8C-KCG-211-010 LENS, LCD	a
		O	MC1024	8C-KCG-212-010 CASE, LCD LENS	a
		X	MC1025	8C-KCA-603-010 PWB, FRONT	a
		O	MC1026	8C-KCG-002-010 CABI, REAR 16	a
		O	MC1027	85-HRL-623-010 JACK, 3.5 BLK ST BLK	a
		O	MC1028	8Z-KC2-203-210 LEVER, DFP HOOK -C2	a
		O	MC1029	8C-KCG-220-010 SPR-C, DETACH HOOK C	a
		O	MC1030	8C-KCG-035-010 CABI, BASE CKC	a
		O	MC1031	8A-KCF-230-010 COVER, DUST DFP LOWRAL	a
		O	MC1032	8Z-KC2-222-010 SPR-T, DETACH LOCK-C2	a
		O	MC1033	8C-KCG-205-010 LEVER, DFP LOCK	a
		O	MC1034	8Z-KC1-231-110 HLDR, HALF -C	a
		O	MC1035	8C-KCG-203-010 CHAS, FRONT G W/O TAP	a
		O	MC1036	8C-KCG-201-010 CHAS, SIDE L C	a
		O	MC1037	8A-KC7-230-210 HLDR, TR2 -AC	a
		X	MC1038	M8-BZG-393-040 BZG-3 CNF	a
		X	MC1039	A8-CZA-590-040 CZA-5 TOSNF	a
		X	MC1039a	8C-ZA5-601-010 PWB, CD 2M (CZA-5)	a
					CDC-R227 YZSF
		O	MC1040	8B-KCG-247-010 HLDR, MECHA AS-BC	a
		X	MC1041	8C-KCG-253-010 PANEL, HT-SINK Z2	a
		X	MC1042	8A-KC7-224-010 HLDR, P-IC -AC	a
		S	MC1043	8B-KC1-621-010 FUSE, 15A 32V	a
		X	MC1044	8C-KCA-601-010 PWB, MAIN (CKC-A)	a
		O	MC1045	8C-KCG-202-010 CHAS, SIDE R C	a
		X	MC1046	8Z-KC1-234-210 SH, PWB	a
		O	MC1047	8Z-KC1-256-010 COVER, BOTTOM RDS	a
		X	MC1048	8C-KCG-221-010 SH, ADH WINDOW	a
		O	MC1049	8C-KCG-661-010 FF-CABLE, 20P 1.0 90MM	a
		X	MC1050	8C-KCA-604-010 PWB, AUX	a
		O	MC1051	8C-KCG-036-010 CABI, TRIM 16	a
		O	MC1052	8Z-KC2-223-010 SPR-C, DETACH -C2	a
		O	MC1053	8C-KC1-012-010 BTN, OV T	a
		O	MC1054	8B-ZG3-607-010 PWB, FLEX PIC 2	a
		O	MC1055	8B-ZG3-273-010 LEVER, DIR STOPPER	a
		X	MC1056	8C-KCG-254-010 HLDR, ISO-WIRE	a
		X	MC1057	8C-KC4-203-010 COVER, BOTTOM KC4	a
		O	MC1A	8Z-KC1-253-010 S-SCREW, PT 2*8 BH+ BLK	a
		O	MC1B	87-B10-384-010 UIT+2.6-6	a
					CDC-R227 YZSF
		O	MC1C	87-081-501-010 VTT+2.6-4	a
		O	MC1D	87-251-097-410 U+3-12	a
		O	MC1E	87-B10-259-010 UT2+3.0-10.0 W/O SLOT (BH TAP)	a
		O	MC1F	87-B10-397-010 UTT2+2.6-4 W/O SLOT	a
		O	MC1G	87-432-903-010 WTE, 2.6	a
		O	MC1H	87-571-032-410 VIT+2-3	a
		O	MC1I	8B-ZG3-287-010 S-SCREW, TH1.7-4 0.5	a
		O	MC1J	87-B10-385-010 UIT+2.6-6 BLK	a
		O	MC1K	87-B10-336-010 VTT+2.6-6 W/O	a

## COLOR NAME TABLE -1/1

Basic color symbol	Color	Basic color symbol	Color	Basic color symbol	Color
B	Black	C	Cream	D	Orange
G	Green	H	Gray	L	Blue
LT	Transparent Blue	N	Gold	P	Pink
R	Red	S	Silver	ST	Titan Silver
T	Brown	V	Violet	W	White
WT	Transparent White	Y	Yellow	YT	Transparent Yellow
LM	Metallic Blue	LL	Light Blue	GT	Transparent Green
LD	Dark Blue	DT	Transparent Orange	GM	Metallic Green
YM	Metallic Yellow	DM	Metallic Orange	PT	Transparent Pink
LA	Aqua Blue	GL	Light Green	HT	Transparent Gray
HM	Metallic Gray	NH	Champagne Gold	M	Wood Pattern

CD MECHANISM EXPLODED VIEW -1/1 (BZG-3 CNF)

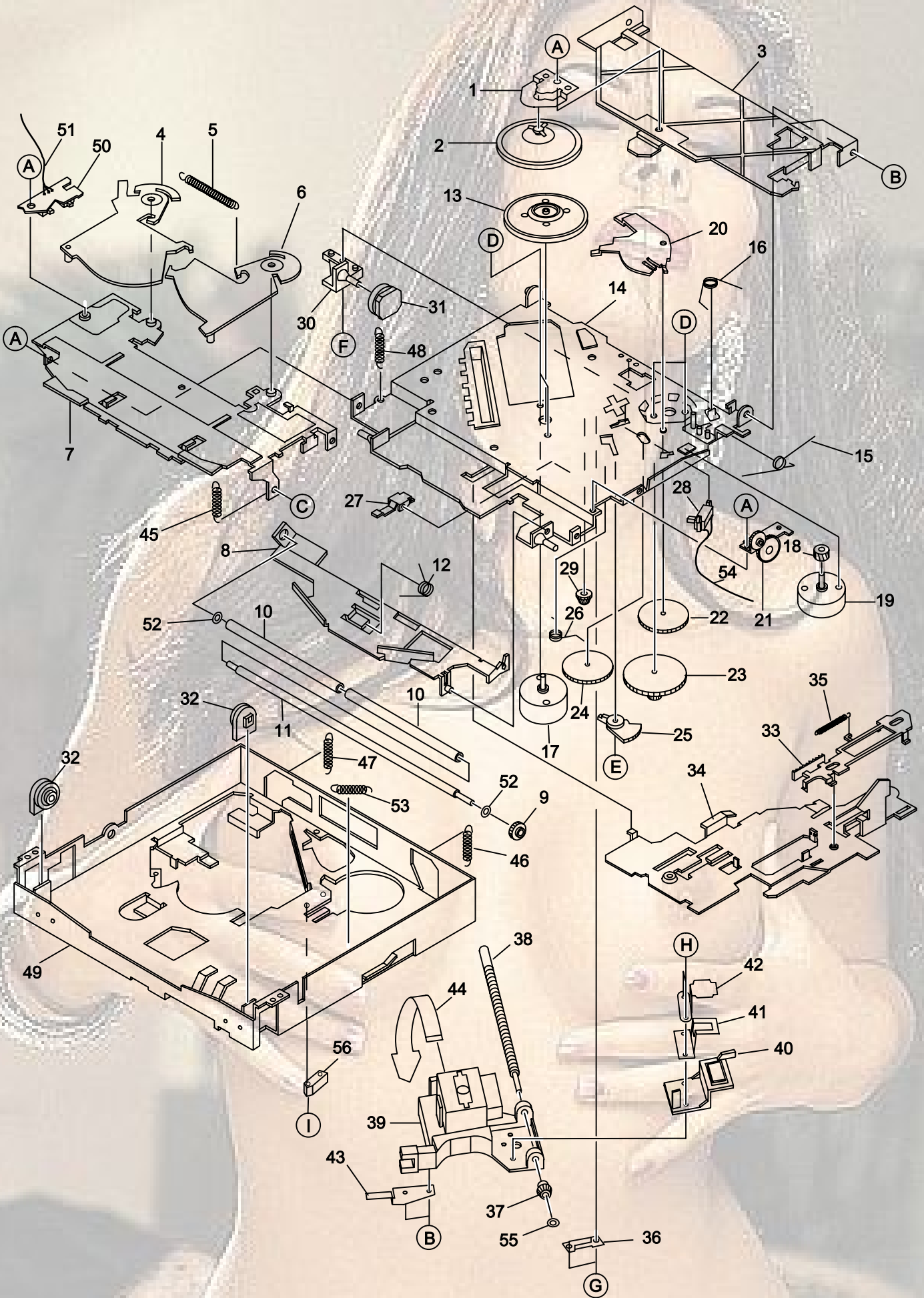



# CD MECHANICAL PARTS LIST -1/2 (BZG-3 CNF)

! = SAFETY PARTS  
C = Components marked

All components used on this model at the production line are shown in this service manual.  
However, please note that not all components will be available as spare parts for after-sales service.  
Components marked S and O are designated as spare parts for service and will be stocked at the spare parts centers.  
Components marked X and R are not designated as spare parts for after sales service, and will not be stocked at the spare parts centers.

UNIT-NAME	! C	REF-NO	PARTS-NO	PARTS-NAME	SUFFIX&MODEL
					BZG-3 CNF
	O	SC1001	8B-ZG3-261-110	SPR-P, CD HOLDER SUPORT	a
	O	SC1002	8B-ZG3-232-210	CLAMP, BZG-3	a
	O	SC1003	8B-ZG3-213-010	LEVER, CD HOLDER	a
	O	SC1004	8B-ZG3-215-210	LEVER, CD L	a
	O	SC1005	8B-ZG3-256-310	SPR-E, CD LEVER	a
	O	SC1006	8B-ZG3-214-010	LEVER, CD R	a
	O	SC1007	8B-ZG3-303-010	LEVER, CD UP HOLDER CNF	a
	O	SC1008	8B-ZG3-212-110	LEVER, CD ROLLER	a
	O	SC1009	8B-ZG3-225-010	GEAR, ROLLER	a
	O	SC1010	8A-ZGA-261-010	ROLLER, RUBBER	a
	O	SC1011	8B-ZG3-241-110	SHAFT, ROLLER	a
	O	SC1012	8B-ZG3-252-010	SPR-T, ROLLER	a
	O	SC1013	8B-ZG3-231-010	TURN TABLE, BZG-3	a
	O	SC1014	8B-ZG3-201-210	CHAS ASSY, BZG-3	a
	X	SC1014a	8B-ZG3-284-010	SHAFT, FLOAT FRONT	a
	X	SC1014b	8B-ZG3-202-210	CHAS ASSY, OUT-SERT	a
	X	SC1014c	8B-ZG3-203-210	CHAS, MAIN	a
	X	SC1014d	8B-ZG3-285-010	SHAFT, GEAR DIR	a
	O	SC1015	8B-ZG3-250-010	SPR-T, CLAMP	a
	O	SC1016	8B-ZG3-253-010	SPR-T, CD SENSOR	a
					BZG-3 CNF
	O	SC1017	87-A92-091-010	MOT, M25E-4	a
	O	SC1018	8B-ZG3-220-010	GEAR, MOT	a
	O	SC1019	87-A92-092-010	MOT, M25E-10	a
	O	SC1020	8B-ZG3-209-110	LEVER ASSY, MODE CH	a
	X	SC1020a	8B-ZG3-210-110	LEVER, MODE CH	a
	X	SC1020b	8B-ZG3-283-010	SHAFT, GEAR 3 DIR	a
	O	SC1021	8B-ZG3-216-010	LEVER ASSY, GEAR HOLDER	a
	X	SC1021a	8B-ZG3-217-010	LEVER, GEAR HOLDER	a
	X	SC1021b	8B-ZG3-224-010	GEAR, SIDE	a
	X	SC1021c	8B-ZG3-226-010	GEAR, WORM ROLLER	a
	X	SC1021d	8B-ZG3-227-010	GEAR, WORM WHL ROLLER	a
	X	SC1021e	8B-ZG3-280-010	SHAFT, GEAR WORM ROLLER	a
	X	SC1021f	8B-ZG3-281-010	SHAFT, GEAR W WHL ROLLER	a
	X	SC1021g	8B-ZG3-282-010	SHAFT, GEAR SIDE	a
	O	SC1022	8B-ZG3-221-010	GEAR, CONNECT	a
	O	SC1023	8B-ZG3-223-010	GEAR, IDL DIR	a
	O	SC1024	8B-ZG3-222-010	GEAR, 3 DIR	a
	O	SC1025	8B-ZG3-230-010	GEAR, CAM	a
	O	SC1026	8B-ZG3-251-210	SPR-T, CAM	a
	O	SC1027	8B-ZG3-207-010	LEVER, DIR DOWN	a
					BZG-3 CNF
	O	SC1028	87-A92-094-010	SW, PUSH 2-1 ESE11SF1XQ	a
	O	SC1029	8B-ZG3-229-010	GEAR, WHL SLD	a
	O	SC1030	8B-ZG3-218-010	HLDR, FLOAT REAR	a
	O	SC1031	8B-ZG3-246-010	OIL-DMPR, BZG-3 R	a
	O	SC1032	8B-ZG3-243-010	OIL-DMPR, BZG-3	a
	X	SC1033	8B-ZG3-206-110	LEVER, DIR UP	a
	O	SC1034	8B-ZG3-205-110	LEVER, DIR	a
	O	SC1035	8B-ZG3-255-010	SPR-E, DIR	a
	O	SC1036	8B-ZG3-260-010	SPR-P, LEAD STOP	a
	O	SC1037	8B-ZG3-228-010	GEAR, SLD	a
	O	SC1038	8B-ZG3-240-010	SHAFT, LEAD JVC	a
	O	SC1039	87-A92-093-010	PICKUP, OPTIMA720 JVC	a
	O	SC1040	8B-ZG3-242-210	HLDR, LEAD	a
	O	SC1041	8B-ZG3-263-010	SPR-P, LEAD	a
	O	SC1042	8B-ZG3-247-110	LEVER, LEAD	a
	O	SC1043	8B-ZG3-262-010	SPR-P, PIC UP	a
	O	SC1044	8B-ZG3-607-010	PWB, FLEX PIC 2	a
	O	SC1045	8B-ZG3-258-010	SPR-E, FLOAT FL	a
	O	SC1046	8B-ZG3-266-010	SPR-E, FLOAT RR	a
	O	SC1047	8B-ZG3-267-010	SPR-E, FLOAT RL	a
					BZG-3 CNF
	O	SC1048	8B-ZG3-257-010	SPR-E, FLOAT FR	a
	O	SC1049	8B-ZG3-301-110	CHAS ASSY, HOLDER CNF	a
	X	SC1049a	8B-ZG3-302-010	CHAS, HOLDER CNF	a
	X	SC1049b	8B-ZG3-291-110	SHAFT, SUPPORT A	a
	X	SC1049c	8B-ZG3-292-110	SHAFT, SUPPORT B	a
	X	SC1050	8B-ZG3-602-010	PWB, SUB 35M	a
	X	SC1051	8B-ZG3-605-010	WIRE, CD SENSOR 3P	a
	O	SC1052	8A-ZGA-265-010	SH, 4.5-2.1-0.25 W/O ADH	a
	O	SC1053	8B-ZG3-268-010	SPR-E, PULL FRONT	a
	X	SC1054	8B-ZG3-604-110	WIRE, LIMT 2P	a
	O	SC1055	87-B10-379-010	W-P, 1.785-3-0.5	a
	O	SC1056	87-A92-368-010	SW, PUSH 2-1 MPU10420MLBO	a
	O	SC1A	87-357-503-310	VT2+1.4-2	a
	O	SC1B	8B-ZG3-245-010	S-SCREW, CD HLDR	a
	O	SC1C	87-067-393-010	S-SCREW, +1.4-1.4	a
	O	SC1D	87-267-523-310	V+1.7-2	a
	O	SC1E	87-B10-361-010	W-P, 1.43-3-0.25 SLIT	a
	O	SC1F	87-571-032-410	VIT+2-3	a
	O	SC1G	87-067-430-010	VT2+1.4-5 SWCH/CR BLK HL	a
	O	SC1H	87-351-527-310	VT2+1.7-3	a



# CD MECHANICAL PARTS LIST -2/2 (BZG-3 CNF)

- ! = ⚠ SAFETY PARTS
- C = Components marked

All components used on this model at the production line are shown in this service manual.  
 However, please note that not all components will be available as spare parts for after-sales service.  
 Components marked S and O are designated as spare parts for service and will be stocked at the spare parts centers.  
 Components marked X and R are not designated as spare parts for after sales service, and will not be stocked at the spare parts centers.

UNIT-NAME	! C REF-NO	PARTS-NO	PARTS-NAME	SUFFIX&MODEL
	O	SC11	87-B10-400-010 VIT+2-6 W/O SLOT	BZG-3 CNF a

# OTHERS PARTS LIST -1/2 (CDC-R227) -1/1

- ! =  $\Delta$  SAFETY PARTS
- C = Components marked

All components used on this model at the production line are shown in this service manual.  
 However, please note that not all components will be available as spare parts for after-sales service.  
 Components marked S and O are designated as spare parts for service and will be stocked at the spare parts centers.  
 Components marked X and R are not designated as spare parts for after sales service, and will not be stocked at the spare parts centers.

UNIT-NAME	! C	REF-NO	PARTS-NO	PARTS-NAME	SUFFIX&MODEL
					CDC-R227
					YZSF
	X		8C-KCA-212-010	SH,3.2-2.4- 0.2 BLK	a
	X		8C-KCG-223-010	SH,5-10-0.07 BLK	a
	X		87-B40-281-010	LBL,BAR-CODE A 35X8	a
	X		87-B40-154-010	LBL,BAR-CODE CU	a
	X		8Z-HC4-028-010	LBL,CLASS 1 & TRIANGLE-G	a
	X		8C-KCA-005-010	LBL,SPEC.YZ R227	a
	X		8C-KCG-255-010	TUBE,ISO WIRE D12	a
	X		87-B40-087-010	BAG,PV 0.04-250-350 PL	a
	X		8C-KCA-852-010	CTN,OUTER 227 YZSF	a
	X		8C-KCA-851-010	CTN,PRINTED 227 YZSF	a
	X		8Z-KC1-871-010	CUSHION,DFP-GUARD	a
	X		8C-KCF-851-010	CUSHION,LEFT AIS	a
	X		8C-KCF-852-010	CUSHION,RIGHT AIS	a
	X		87-B40-454-010	BAG,PP 0.04-230-350 PL	a
	X		87-056-168-010	SH,CAUTION INF-WARR(EC)	a
	X		8B-KCF-907-110	SH,CD-R/RW YZ,YV (9L,R)-I	a
	X		8C-KCA-907-010	SH,DEMO YZ(9L)F R227	a
	X		8C-KCG-906-010	SH,SCREW DFP (14L)F	a
	X		8C-KC4-920-010	SH,STOPPER (14L)F	a
	X		87-B40-178-010	BAG,PV 0.04-100-250	a
					CDC-R227
					YZSF
	X		87-B40-179-010	BAG,PV 0.04-50-100	a
	X		87-B40-242-010	BAG,PV 0.04-70-100	a
	X		8C-KCG-233-010	CUSHION,DFP-CASE	a

# OTHERS PARTS LIST -2/2 (BZG-3 CNF) -1/1

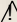
- ! =  SAFETY PARTS
- C = Components marked

All components used on this model at the production line are shown in this service manual.  
 However, please note that not all components will be available as spare parts for after-sales service.  
 Components marked S and O are designated as spare parts for service and will be stocked at the spare parts centers.  
 Components marked X and R are not designated as spare parts for after sales service, and will not be stocked at the spare parts centers.

UNIT-NAME	! C	REF-NO	PARTS-NO	PARTS-NAME	SUFFIX&MODEL
					BZG-3 CNF
	X		8B-ZG3-248-110	SH, CLAMP	a
	X		8B-ZG3-270-010	SH, DUMP	a
	X		8B-ZG3-244-310	SH, LVR CD HLDR	a



**アイワ株式会社** 〒110-8710 東京都台東区池之端1-2-11 ☎03(3827)3111 (代表)  
**AIWA CO.,LTD.** 2-11, IKENOHATA 1-CHOME, TAITO-KU, TOKYO 110-8710, JAPAN TEL:03 (3827) 3111